

A map of Richardson, Texas, showing various streets and landmarks. The map is overlaid with a blue and white geometric design. The text 'CITY OF RICHARDSON' and 'GPS Control Network' is centered over the map.

# CITY OF RICHARDSON

## GPS Control Network



**RICHARDSON**

**TEXAS**



Issued:  
May 2020

Established by:  
CP&Y, Inc.  
1820 Regal Row, Suite 150  
Dallas, TX 75235  
214.638.0500

# CITY OF RICHARDSON

## GPS CONTROL SHEET

Established By:



TBPELS FIRM NO. 10194115

<b>MONUMENT NAME:</b> MON. NO. 101	<b>DATE ESTABLISHED:</b> FEBRUARY 2020	<b>COUNTY:</b> COLLIN	<b>STATE:</b> TEXAS
<b>GEODETTIC POSITION</b> LATITUDE N 32° 59' 47.76644" LONGITUDE W 96° 45' 19.71346"		GEOID03, NAD-83 (CORS 96) GRID DATA TEXAS STATE PLANE COORDINATES NORTH CENTRAL ZONE 4202 (METERS) NORTHING (Y) 2,148,829.57 EASTING (X) 763,009.445	
ELLIPSOID HEIGHT (METERS) 190.109 GEOID HEIGHT (METERS) -26.223	GEOID03, NAD-83 (CORS 96) GRID DATA TEXAS STATE PLANE COORDINATES NORTH CENTRAL ZONE 4202 (U.S. SURVEY FEET) NORTHING (Y) 7,049,951.680 EASTING (X) 2,503,306.821		
GEOID MODEL: GEOID12B		NAVD-88 ELEVATION: 709.75 (U.S. SURVEY FEET)	

**NOTE:**

3-1/4 INCH ALUMINUM DISC SET IN THE MIDDLE OF A CURB INLET IN THE MEDIAN OF WATERVIEW PARKWAY, ±95.7 FEET SOUTHWEST OF THE MEDIAN NOSE AND ±140 FEET SOUTHWEST OF THE CENTERLINE OF FRANKFORD ROAD.

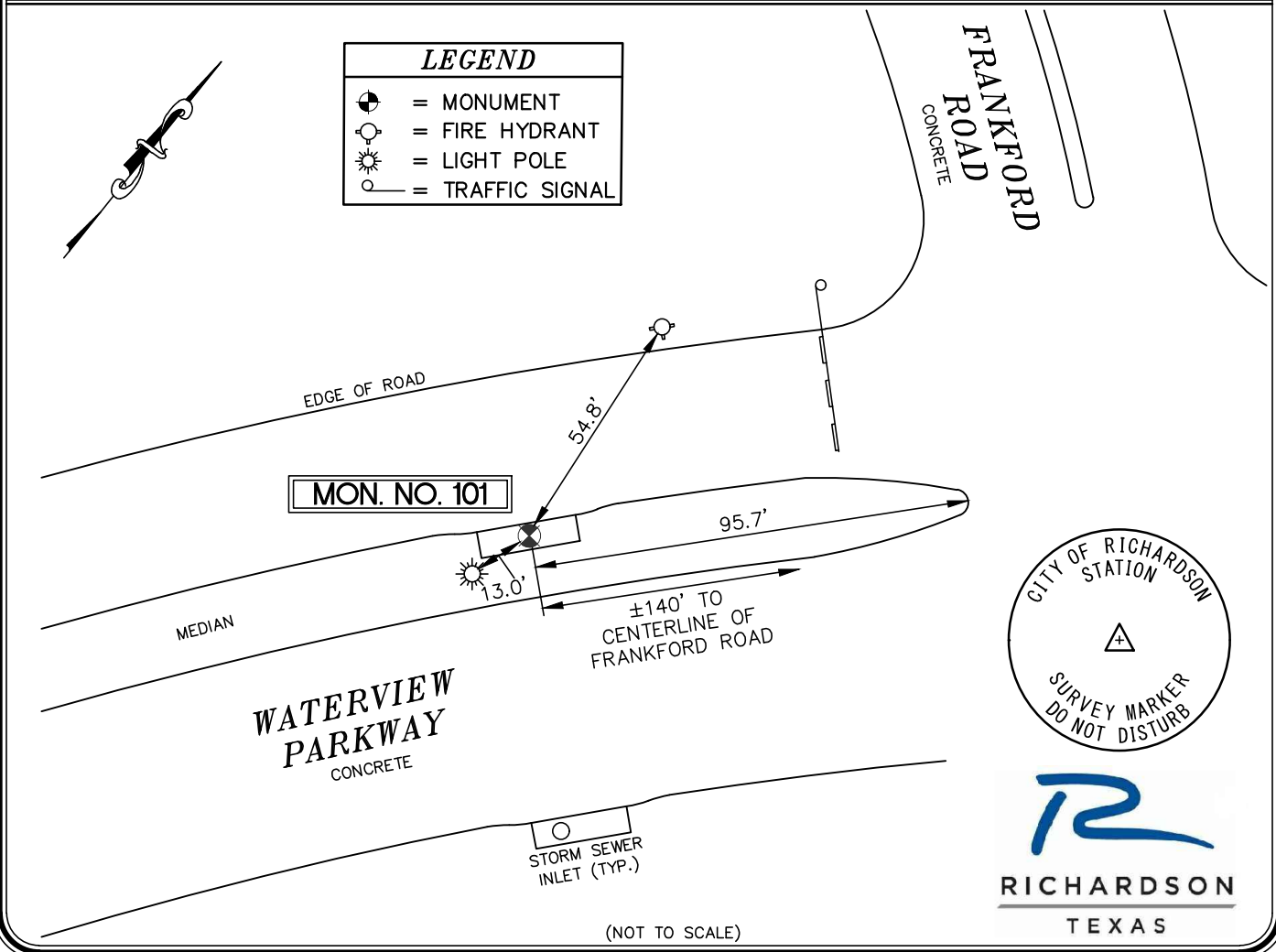

# CITY OF RICHARDSON

## GPS CONTROL SHEET

Established By:



TBPELS FIRM NO. 10194115

MONUMENT NAME: MON. NO. 102	DATE ESTABLISHED: FEBRUARY 2020	COUNTY: COLLIN	STATE: TEXAS
GEODETTIC POSITION LATITUDE N 32° 59' 51.56984" LONGITUDE W 96° 43' 39.78804"		GEOID03, NAD-83 (CORS 96) GRID DATA TEXAS STATE PLANE COORDINATES NORTH CENTRAL ZONE 4202 (METERS) NORTHING (Y) 2,148,990.121 EASTING (X) 765,600.862	
ELLIPSOID HEIGHT (METERS)	173.431	GEOID03, NAD-83 (CORS 96) GRID DATA TEXAS STATE PLANE COORDINATES NORTH CENTRAL ZONE 4202 (U.S. SURVEY FEET) NORTHING (Y) 7,050,478.422 EASTING (X) 2,511,808.828	
GEOID HEIGHT (METERS)	-26.125		
GEOID MODEL: GEOID12B		NAVD-88 ELEVATION: 654.710 (U.S. SURVEY FEET)	

**NOTE:**

3-1/4 INCH ALUMINUM DISC SET IN THE MIDDLE OF A CURB INLET ON THE NORTH SIDE OF RENNER ROAD, ±360.0 FEET EAST OF CUSTER PARKWAY.

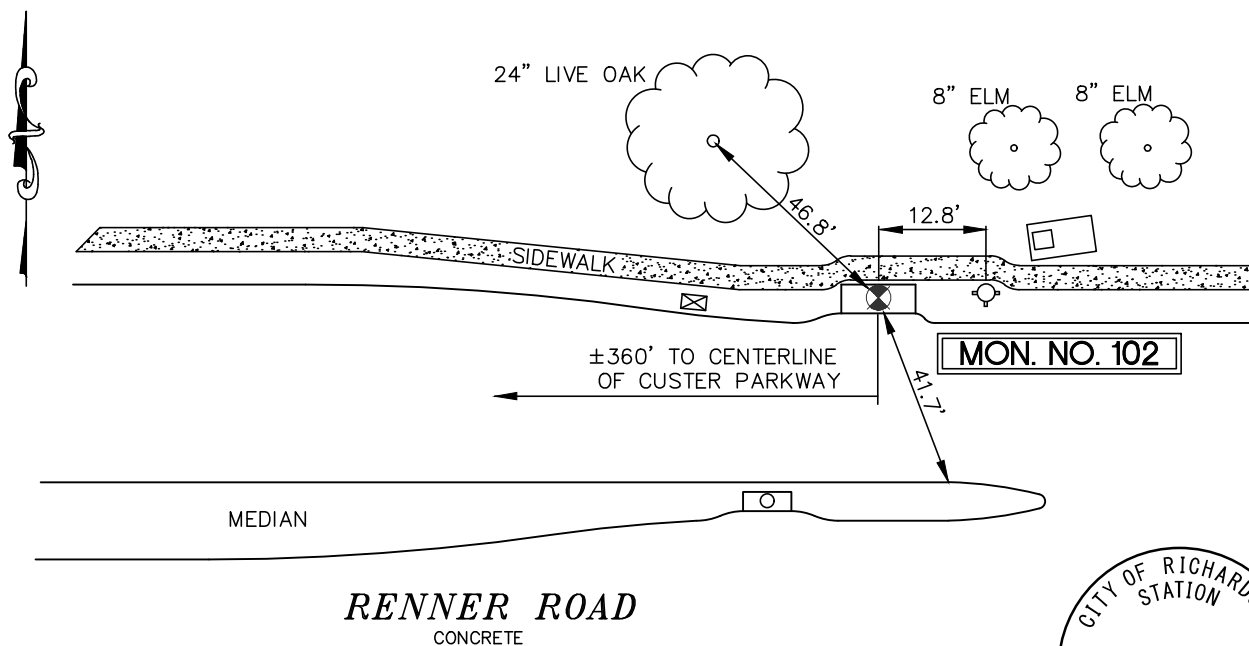

<b>LEGEND</b>	
	= MONUMENT
	= FIRE HYDRANT
	= WATER VAULT
	= COMMUNICATIONS BOX
	= TREE



(NOT TO SCALE)

# CITY OF RICHARDSON

## GPS CONTROL SHEET

Established By:



TBPELS FIRM NO. 10194115

<b>MONUMENT NAME:</b> MON. NO. 103	<b>DATE ESTABLISHED:</b> FEBRUARY 2020	<b>COUNTY:</b> COLLIN	<b>STATE:</b> TEXAS
<b>GEODETTIC POSITION</b>  LATITUDE N 32° 59' 50.09096" LONGITUDE W 96° 42' 23.49202"		GEOID03, NAD-83 (CORS 96) GRID DATA TEXAS STATE PLANE COORDINATES NORTH CENTRAL ZONE 4202 (METERS) NORTHING (Y) 2,148,978.182 EASTING (X) 767,581.741	
ELLIPSOID HEIGHT (METERS)                      153.135  GEOID HEIGHT (METERS)                              -26.052	GEOID03, NAD-83 (CORS 96) GRID DATA TEXAS STATE PLANE COORDINATES NORTH CENTRAL ZONE 4202 (U.S. SURVEY FEET) NORTHING (Y) 7,050,439.252 EASTING (X) 2,518,307.762		
GEOID MODEL: GEOID12B		NAVD-88 ELEVATION: 587.88 (U.S. SURVEY FEET)	

**NOTE:**

3-1/4 INCH ALUMINUM DISC SET IN THE CENTER OF A CONCRETE MEDIAN IN THE CENTER OF A BRIDGE ON RENNEN ROAD ±807 FEET EAST OF THE CENTERLINE OF U.S. HIGHWAY 75.

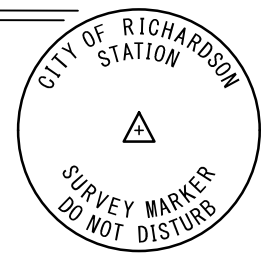
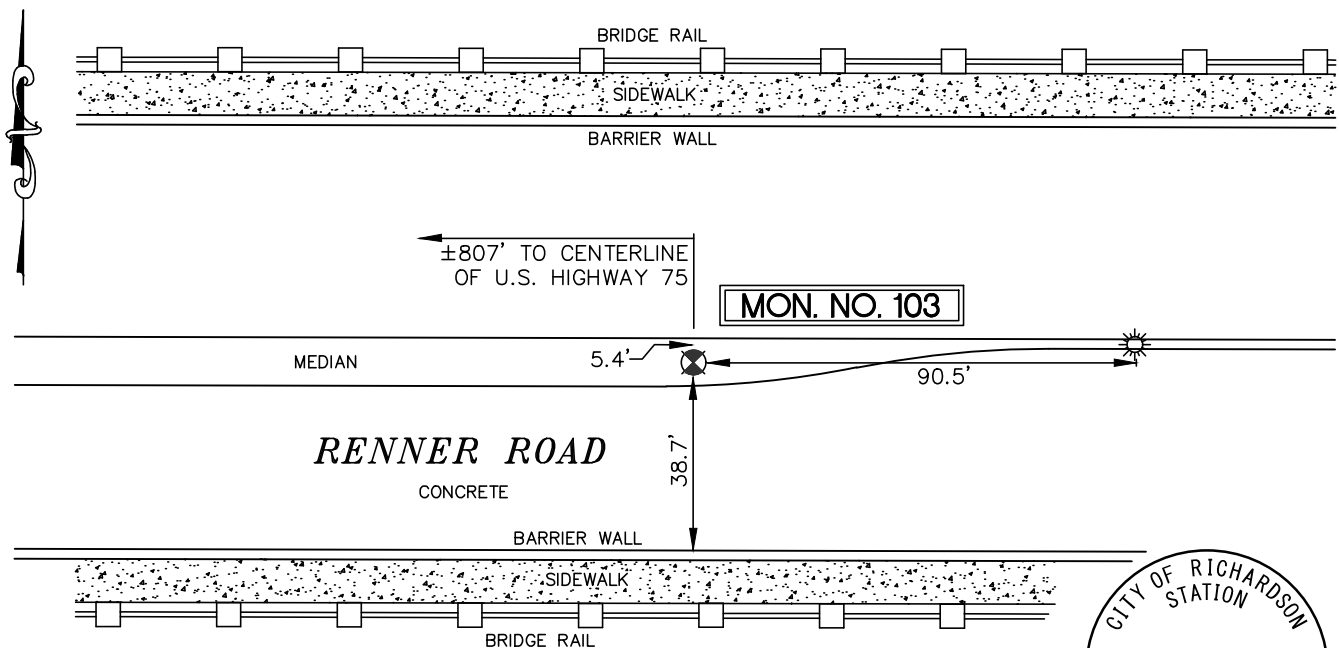

<i>LEGEND</i>	
	= MONUMENT
	= STREET LIGHT



(NOT TO SCALE)

# CITY OF RICHARDSON

## GPS CONTROL SHEET

Established By:



TBPELS FIRM NO. 10194115

<b>MONUMENT NAME:</b> MON. NO. 104	<b>DATE ESTABLISHED:</b> FEBRUARY 2020	<b>COUNTY:</b> COLLIN	<b>STATE:</b> TEXAS
<b>GEODETTIC POSITION</b>  LATITUDE N 32° 59' 50.24562" LONGITUDE W 96° 40' 19.51280"		GEOID03, NAD-83 (CORS 96) GRID DATA TEXAS STATE PLANE COORDINATES NORTH CENTRAL ZONE 4202 (METERS) NORTHING (Y) 2,149,038.409 EASTING (X) 770,799.276	
ELLIPSOID HEIGHT (METERS)                      159.309  GEOID HEIGHT (METERS)                              -25.936	GEOID03, NAD-83 (CORS 96) GRID DATA TEXAS STATE PLANE COORDINATES NORTH CENTRAL ZONE 4202 (U.S. SURVEY FEET) NORTHING (Y) 7,050,636.847 EASTING (X) 2,528,863.958		
GEOID MODEL: GEOID12B		NAVD-88 ELEVATION: 607.76 (U.S. SURVEY FEET)	

**NOTE:**

3-1/4 INCH ALUMINUM DISC SET IN THE MEDIAN AT THE INTERSECTION OF THE SOUTH BOUND SERVICE ROAD FOR THE PRESIDENT GEORGE BUSH TURNPIKE (P.G.B.T.) AND WEST BOUND RENNER ROAD.

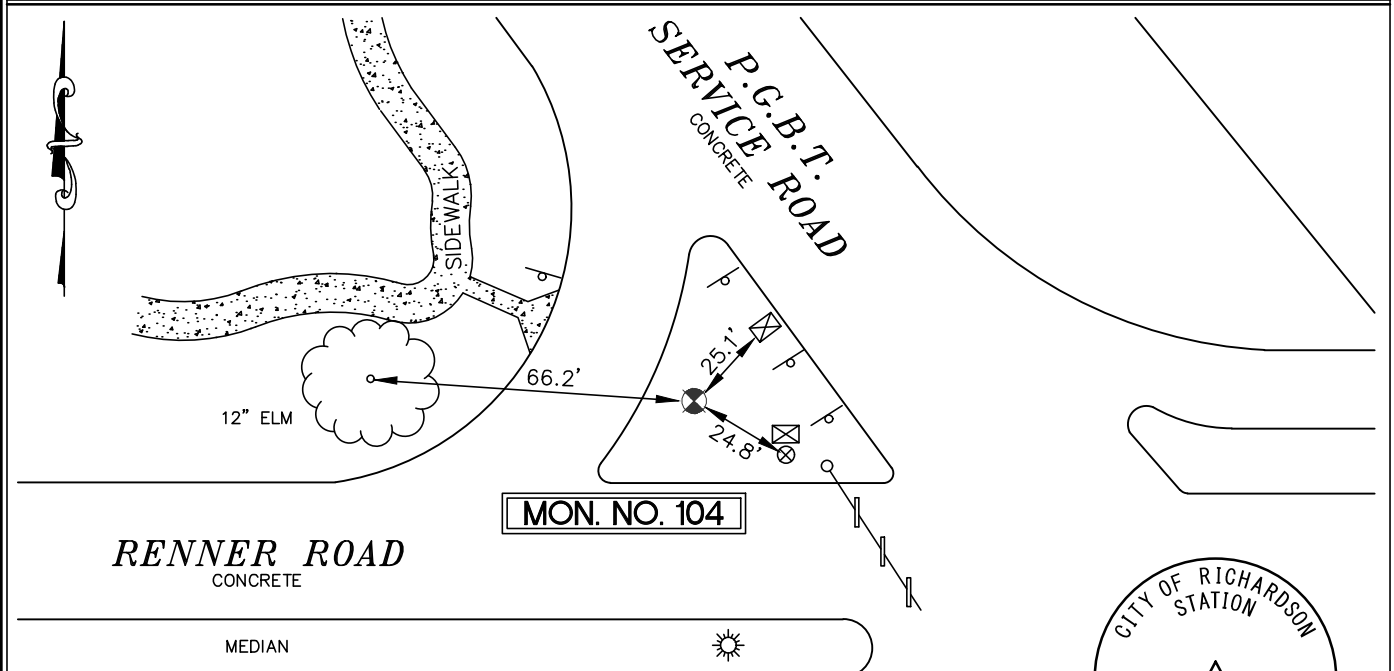

<b>LEGEND</b>	
	= MONUMENT
	= STREET SIGN
	= STREET LIGHT
	= UTILITY BOX
	= TRAFFIC SIGNAL
	= WALK/DON'T WALK SIGNAL
	= TREE



(NOT TO SCALE)



# CITY OF RICHARDSON

## GPS CONTROL SHEET

Established By:



TBPELS FIRM NO. 10194115

<b>MONUMENT NAME:</b> MON. NO. 105	<b>DATE ESTABLISHED:</b> FEBRUARY 2020	<b>COUNTY:</b> COLLIN	<b>STATE:</b> TEXAS
<b>GEODETTIC POSITION</b>  LATITUDE N 33° 00' 06.14005" LONGITUDE W 96° 38' 38.45695"		GEOID03, NAD-83 (CORS 96) GRID DATA TEXAS STATE PLANE COORDINATES NORTH CENTRAL ZONE 4202 (METERS) NORTHING (Y) 2,149,573.916 EASTING (X) 773,413.302	
ELLIPSOID HEIGHT (METERS)	145.292	GEOID03, NAD-83 (CORS 96) GRID DATA TEXAS STATE PLANE COORDINATES NORTH CENTRAL ZONE 4202 (U.S. SURVEY FEET) NORTHING (Y) 7,052,393.756 EASTING (X) 2,537,440.142	
GEOID HEIGHT (METERS)	-25.845		
GEOID MODEL: GEOID12B		NAVD-88 ELEVATION: 561.47 (U.S. SURVEY FEET)	

**NOTE:**

3-1/4 INCH ALUMINUM DISC SET ON THE SOUTHEAST END OF A CURB INLET AT THE NORTHEAST SIDE OF NORTH STAR ROAD ±155 FEET NORTHWEST OF THE CENTERLINE OF RENNER ROAD.

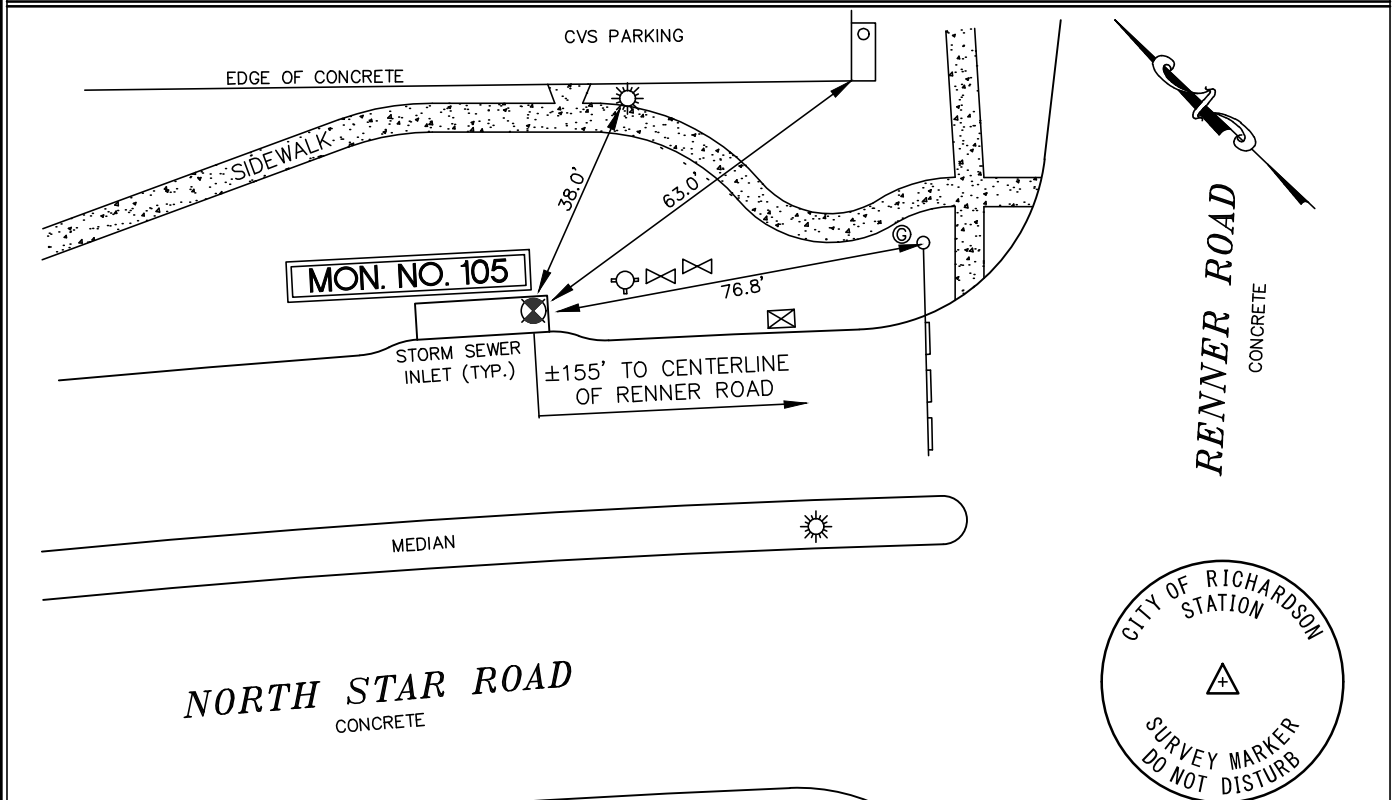

LEGEND	
☉	= MONUMENT
⊙	= GAS METER
⊕	= FIRE HYDRANT
⊗	= WATER VALVE
☀	= STREET LIGHT
⊠	= ELECTRIC BOX
⊙	= TRAFFIC LIGHT

(NOT TO SCALE)

# CITY OF RICHARDSON

## GPS CONTROL SHEET

Established By:



TBPELS FIRM NO. 10194115

<b>MONUMENT NAME:</b> MON. NO. 106	<b>DATE ESTABLISHED:</b> FEBRUARY 2020	<b>COUNTY:</b> COLLIN	<b>STATE:</b> TEXAS
<b>GEODETTIC POSITION</b>  LATITUDE N 33° 00' 00.94763" LONGITUDE W 96° 37' 21.89730"		GEOID03, NAD-83 (CORS 96) GRID DATA TEXAS STATE PLANE COORDINATES NORTH CENTRAL ZONE 4202 (METERS) NORTHING (Y) 2,149,449.306 EASTING (X) 775,402.985	
ELLIPSOID HEIGHT (METERS)	143.17	GEOID03, NAD-83 (CORS 96) GRID DATA TEXAS STATE PLANE COORDINATES NORTH CENTRAL ZONE 4202 (U.S. SURVEY FEET) NORTHING (Y) 7,051,984.931 EASTING (X) 2,543,967.960	
GEOID HEIGHT (METERS)	-25.781		
GEOID MODEL: GEOID12B		NAVD-88 ELEVATION: 554.30 (U.S. SURVEY FEET)	

**NOTE:**

3-1/4 INCH ALUMINUM DISC SET IN THE BACK CORNER OF A CURB INLET ON THE SOUTH SIDE OF RENNER ROAD, ±98.0 FEET WEST OF THE CENTERLINE OF BRAND ROAD.

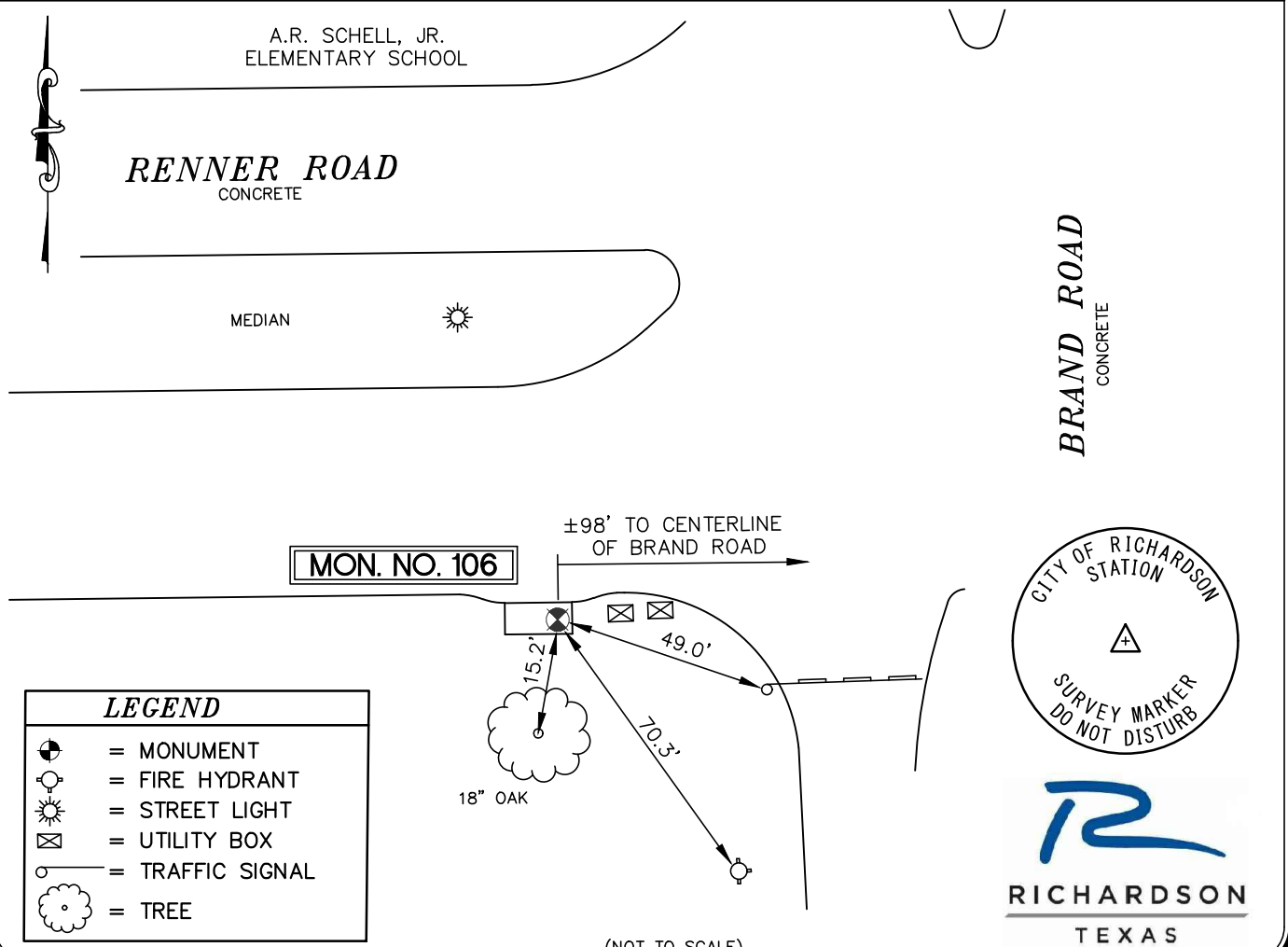

(NOT TO SCALE)

# CITY OF RICHARDSON

## GPS CONTROL SHEET

Established By:



TBPELS FIRM NO. 10194115

MONUMENT NAME: MON. NO. 107	DATE ESTABLISHED: FEBRUARY 2020	COUNTY: COLLIN	STATE: TEXAS
GEODETIC POSITION LATITUDE N 32° 59' 21.16334" LONGITUDE W 96° 38' 27.45280"		GEOID03, NAD-83 (CORS 96) GRID DATA TEXAS STATE PLANE COORDINATES NORTH CENTRAL ZONE 4202 (METERS) NORTHING (Y) 2,148,193.771 EASTING (X) 773,723.39	
ELLIPSOID HEIGHT (METERS) 145.014 GEOID HEIGHT (METERS) -25.842	GEOID03, NAD-83 (CORS 96) GRID DATA TEXAS STATE PLANE COORDINATES NORTH CENTRAL ZONE 4202 (U.S. SURVEY FEET) NORTHING (Y) 7,047,865.730 EASTING (X) 2,538,457.489		
GEOID MODEL: GEOID12B		NAVD-88 ELEVATION: 560.55 (U.S. SURVEY FEET)	

**NOTE:**

3-1/4 INCH ALUMINUM DISC SET IN THE MIDDLE OF A CURB INLET ON THE NORTH SIDE OF GREENFIELD DRIVE, ±130.0 FEET WEST OF THE CENTERLINE OF NORTH STAR ROAD.

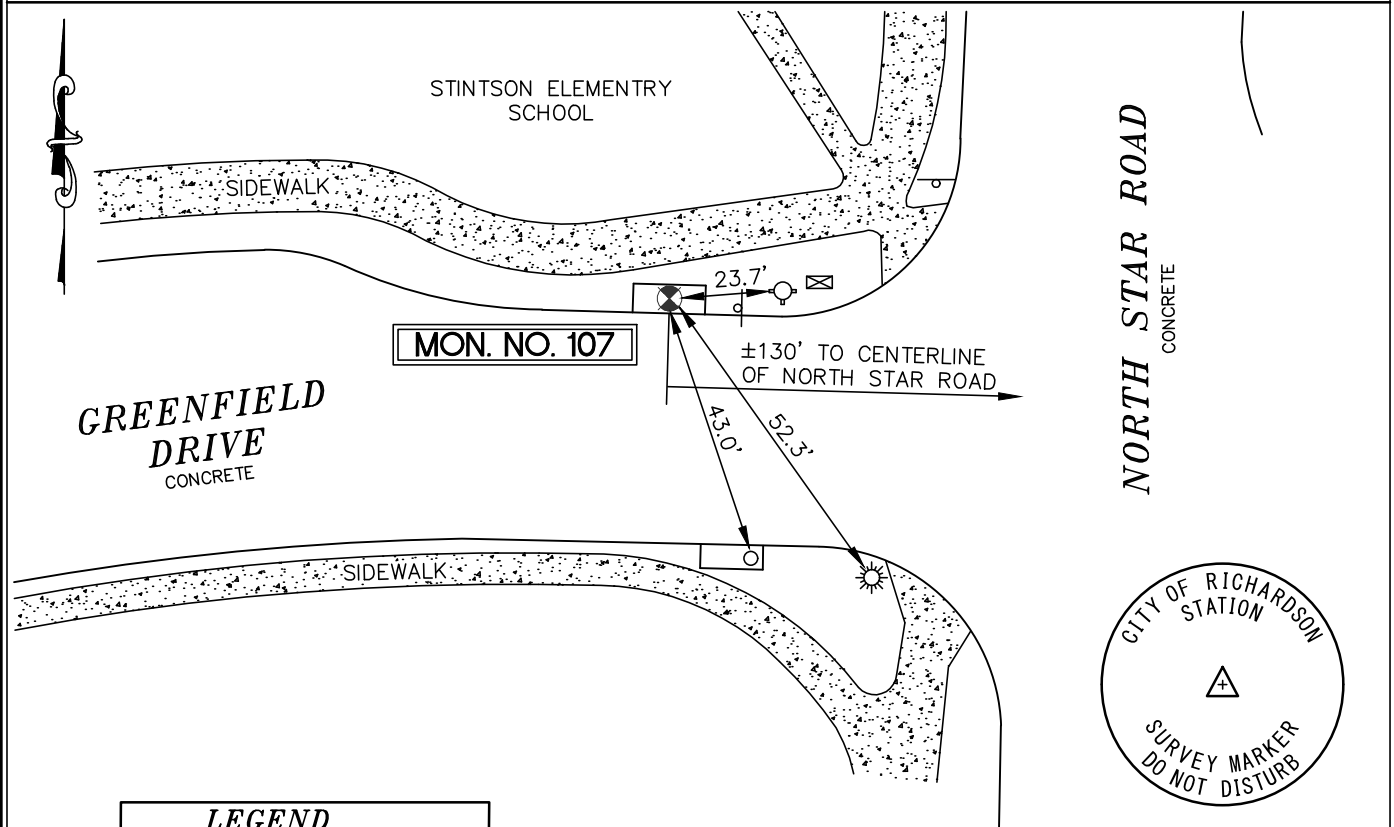

<i>LEGEND</i>	
	= MONUMENT
	= FIRE HYDRANT
	= STREET SIGN
	= COMMUNICATIONS BOX
	= STREET LIGHT



(NOT TO SCALE)



# CITY OF RICHARDSON

## GPS CONTROL SHEET

Established By:



TBPELS FIRM NO. 10194115

MONUMENT NAME: MON. NO. 108	DATE ESTABLISHED: FEBRUARY 2020	COUNTY: COLLIN	STATE: TEXAS
GEODETTIC POSITION LATITUDE N 32° 59' 18.71952" LONGITUDE W 96° 44' 10.89949"		GEOID03, NAD-83 (CORS 96) GRID DATA TEXAS STATE PLANE COORDINATES NORTH CENTRAL ZONE 4202 (METERS) NORTHING (Y) 2,147,964.790 EASTING (X) 764,810.415	
ELLIPSOID HEIGHT (METERS)	173.103	GEOID03, NAD-83 (CORS 96) GRID DATA TEXAS STATE PLANE COORDINATES NORTH CENTRAL ZONE 4202 (U.S. SURVEY FEET) NORTHING (Y) 7,047,114.482 EASTING (X) 2,509,215.503	
GEOID HEIGHT (METERS)	-26.162		
GEOID MODEL: GEOID12B		NAVD-88 ELEVATION: 653.76 (U.S. SURVEY FEET)	

**NOTE:**

3-1/4 INCH ALUMINUM DISC SET ON THE NORTH END OF A CURB INLET ON THE WEST SIDE OF CANYON CREEK DRIVE ±135 FEET NORTH OF THE CENTERLINE OF FAIRWAY DRIVE.

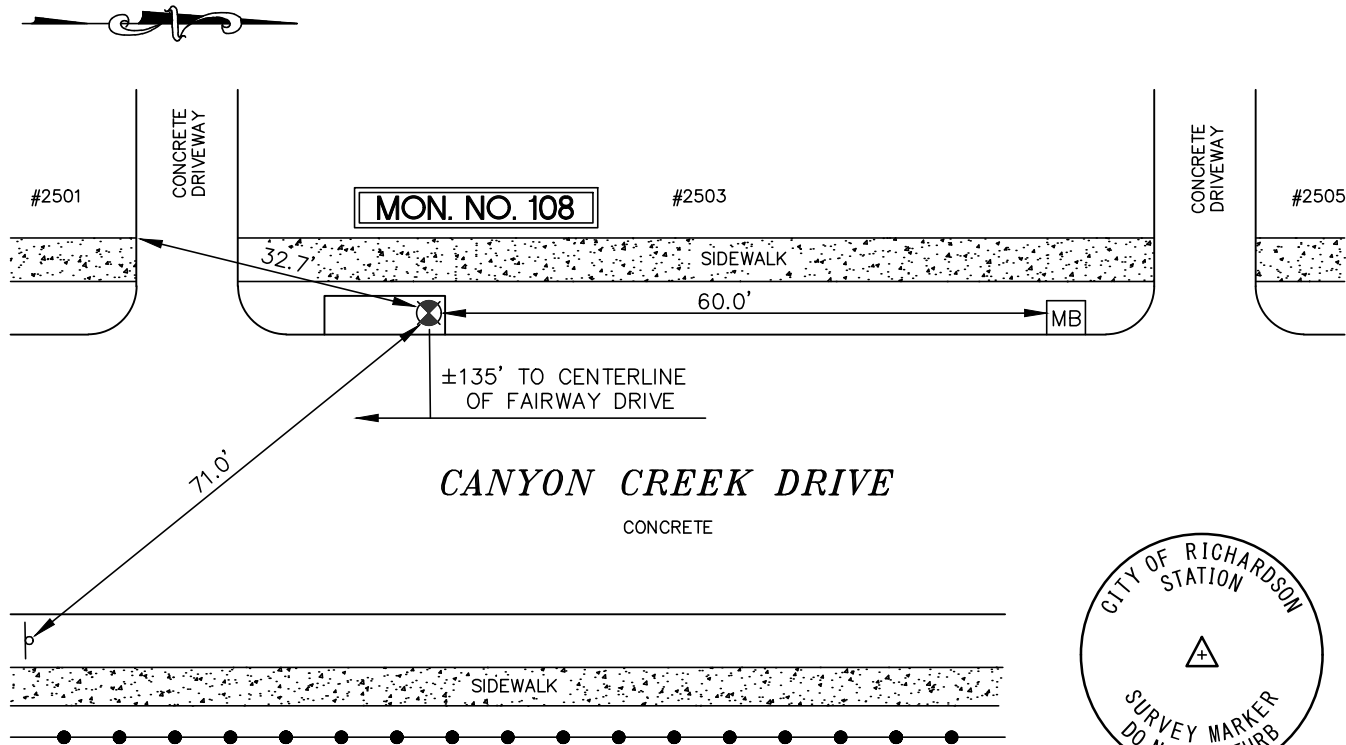

LEGEND	
⊕	= MONUMENT
○	= STREET SIGN
MB	= BRICK MAILBOX
●—●	= WOODEN FENCE

(NOT TO SCALE)

# CITY OF RICHARDSON

## GPS CONTROL SHEET

Established By:



TBPELS FIRM NO. 10194115

<b>MONUMENT NAME:</b> MON. NO. 109	<b>DATE ESTABLISHED:</b> FEBRUARY 2020	<b>COUNTY:</b> DALLAS	<b>STATE:</b> TEXAS
<b>GEODETTIC POSITION</b>  LATITUDE N 32° 58' 58.53414" LONGITUDE W 96° 45' 25.18027"		GEOID03, NAD-83 (CORS 96) GRID DATA TEXAS STATE PLANE COORDINATES NORTH CENTRAL ZONE 4202 (METERS) NORTHING (Y) 2,147,310.928 EASTING (X) 762,892.722	
ELLIPSOID HEIGHT (METERS)                      175.292  GEOID HEIGHT (METERS)                              -26.241	GEOID03, NAD-83 (CORS 96) GRID DATA TEXAS STATE PLANE COORDINATES NORTH CENTRAL ZONE 4202 (U.S. SURVEY FEET) NORTHING (Y) 7,044,969.270 EASTING (X) 2,502,923.872		
GEOID MODEL: GEOID12B		NAVD-88 ELEVATION: 661.20 (U.S. SURVEY FEET)	

**NOTE:**

3-1/4 INCH ALUMINUM DISC SET AT THE EAST END OF A HEADWALL ON THE NORTH SIDE OF CULLUM STREET IN BETWEEN SOUTH BOUND WATERVIEW PARKWAY AND NORTH BOUND WATERVIEW PARKWAY.

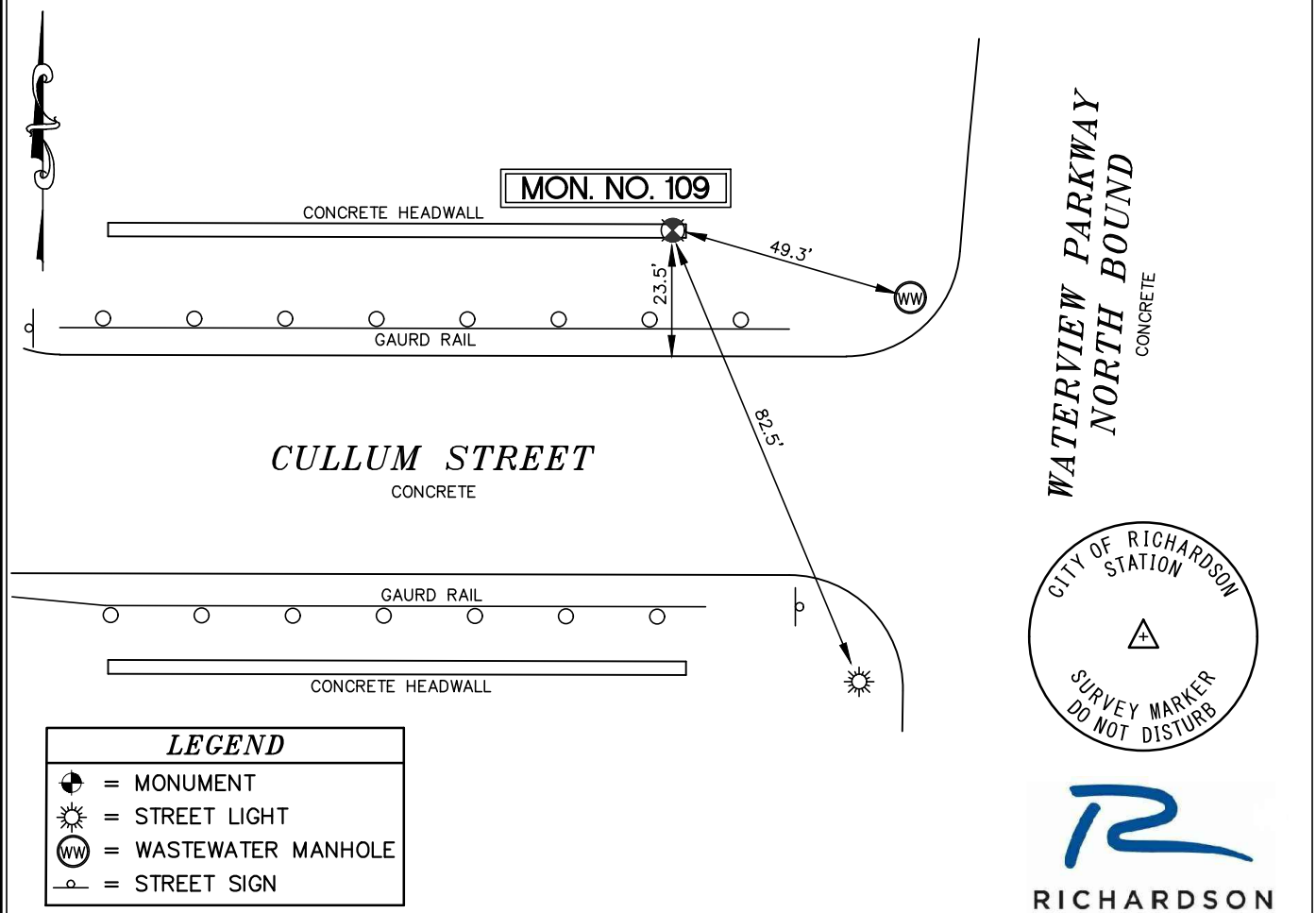

(NOT TO SCALE)

# CITY OF RICHARDSON

## GPS CONTROL SHEET

Established By:



TBPELS FIRM NO. 10194115

<b>MONUMENT NAME:</b> MON. NO. 110	<b>DATE ESTABLISHED:</b> FEBRUARY 2020	<b>COUNTY:</b> DALLAS	<b>STATE:</b> TEXAS
<b>GEODETTIC POSITION</b>  LATITUDE N 32° 58' 14.83428" LONGITUDE W 96° 45' 55.99231"		GEOID03, NAD-83 (CORS 96) GRID DATA TEXAS STATE PLANE COORDINATES NORTH CENTRAL ZONE 4202 (METERS) NORTHING (Y) 2,145,951.796 EASTING (X) 762,115.145	
ELLIPSOID HEIGHT (METERS)                      173.370  GEOID HEIGHT (METERS)                              -26.283	GEOID03, NAD-83 (CORS 96) GRID DATA TEXAS STATE PLANE COORDINATES NORTH CENTRAL ZONE 4202 (U.S. SURVEY FEET) NORTHING (Y) 7,040,510.184 EASTING (X) 2,500,372.772		
GEOID MODEL: GEOID12B		NAVD-88 ELEVATION: 655.03 (U.S. SURVEY FEET)	

**NOTE:**

3-1/4 INCH ALUMINUM DISC SET AT THE WEST END OF A CURB INLET ON THE NORTH SIDE OF MELROSE DRIVE ±1,015 FEET EAST OF THE CENTERLINE OF N. COIT ROAD IN FRONT OF J.J. PEARCE HIGH SCHOOL SOCCER FIELD.

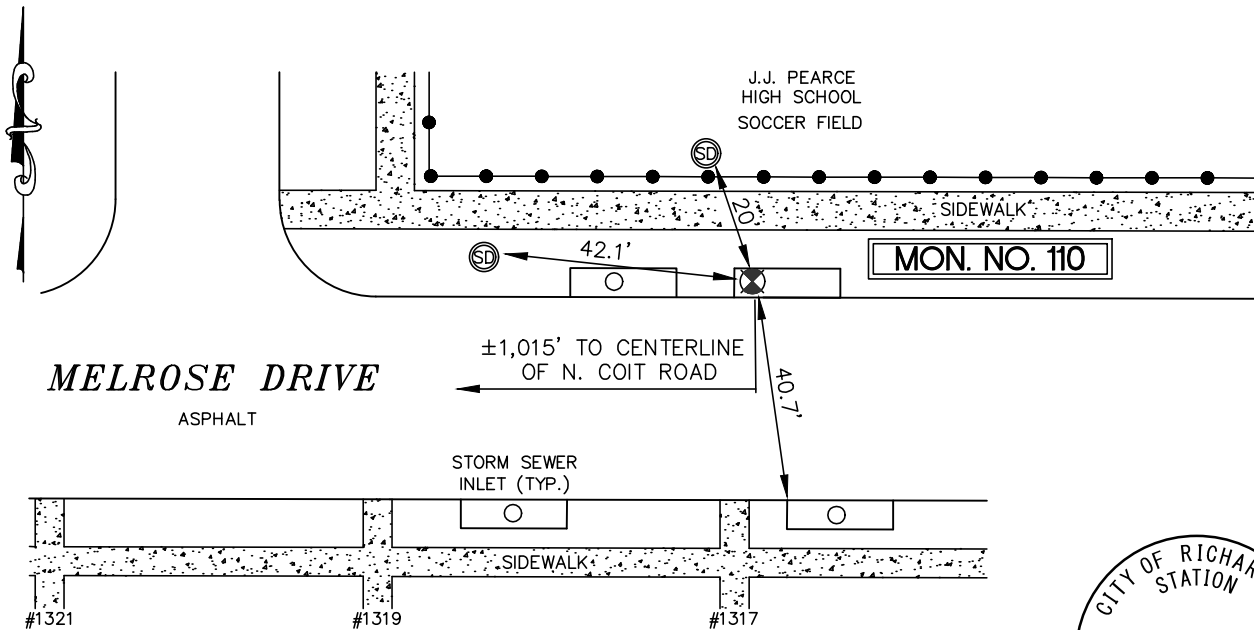

<b>LEGEND</b>	
	= MONUMENT
	= STREET SIGN
	= STORM DRAIN MANHOLE
	= CHAINLINK FENCE



(NOT TO SCALE)

# CITY OF RICHARDSON

## GPS CONTROL SHEET

Established By:



TBPELS FIRM NO. 10194115

<b>MONUMENT NAME:</b> MON. NO. 111	<b>DATE ESTABLISHED:</b> FEBRUARY 2020	<b>COUNTY:</b> DALLAS	<b>STATE:</b> TEXAS
<b>GEODETTIC POSITION</b>  LATITUDE N 32° 58' 31.78520" LONGITUDE W 96° 44' 21.85782"		GEOID03, NAD-83 (CORS 96) GRID DATA TEXAS STATE PLANE COORDINATES NORTH CENTRAL ZONE 4202 (METERS) NORTHING (Y) 2,146,514.514 EASTING (X) 764,550.212	
ELLIPSOID HEIGHT (METERS)                      177.067  GEOID HEIGHT (METERS)                              -26.183	GEOID03, NAD-83 (CORS 96) GRID DATA TEXAS STATE PLANE COORDINATES NORTH CENTRAL ZONE 4202 (U.S. SURVEY FEET) NORTHING (Y) 7,042,356.368 EASTING (X) 2,508,361.821		
GEOID MODEL: GEOID12B		NAVD-88 ELEVATION: 666.83 (U.S. SURVEY FEET)	

**NOTE:**

3-1/4 INCH ALUMINUM DISC SET AT THE BACK CORNER OF A CURB INLET ON THE SOUTH SIDE OF OLD CAMPBELL ROAD ±1,132 FEET WEST OF THE CENTERLINE OF W. CAMPBELL ROAD AND ±196 FEET EAST OF THE CENTERLINE OF NANTUCKET DRIVE.

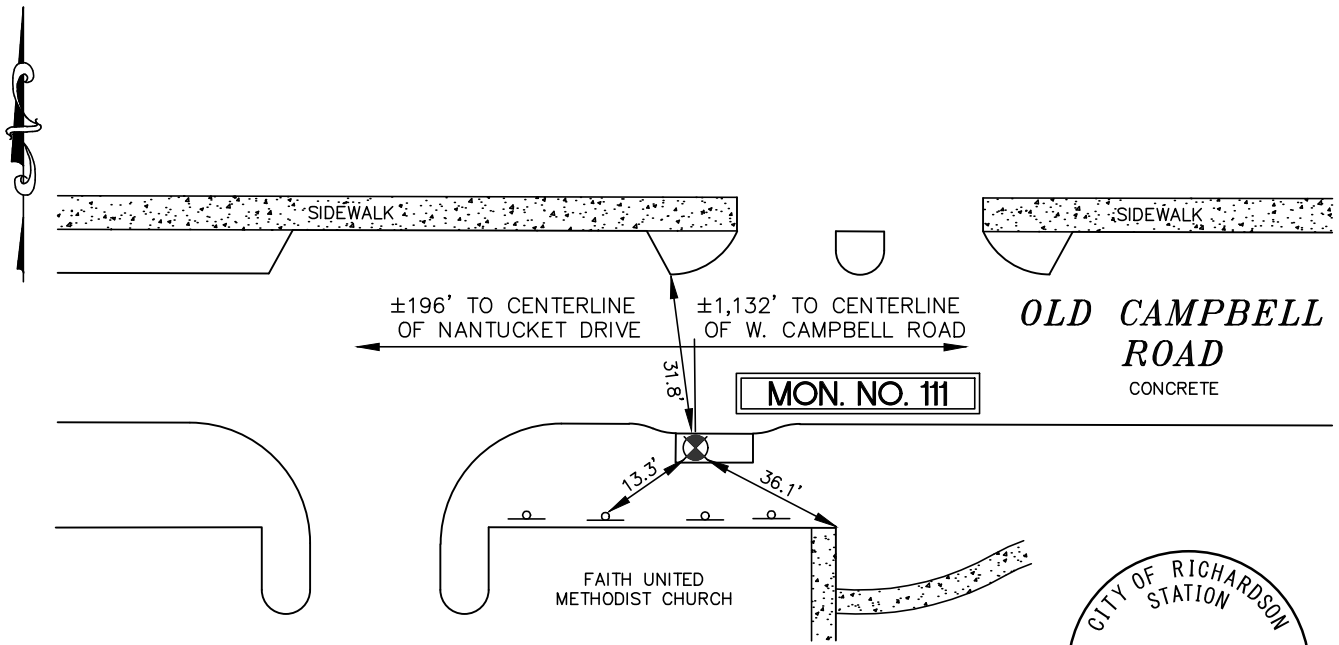

<i><b>LEGEND</b></i>	
	= MONUMENT
	= STREET SIGN



(NOT TO SCALE)

# CITY OF RICHARDSON

## GPS CONTROL SHEET

Established By:



TBPELS FIRM NO. 10194115

<b>MONUMENT NAME:</b> MON. NO. 112	<b>DATE ESTABLISHED:</b> FEBRUARY 2020	<b>COUNTY:</b> DALLAS	<b>STATE:</b> TEXAS
<b>GEODETTIC POSITION</b>  LATITUDE N 32° 58' 38.48282" LONGITUDE W 96° 43' 10.91906"		GEOID03, NAD-83 (CORS 96) GRID DATA TEXAS STATE PLANE COORDINATES NORTH CENTRAL ZONE 4202 (METERS) NORTHING (Y) 2,146,751.827 EASTING (X) 766,388.245	
ELLIPSOID HEIGHT (METERS)                      169.693  GEOID HEIGHT (METERS)                              -26.111	GEOID03, NAD-83 (CORS 96) GRID DATA TEXAS STATE PLANE COORDINATES NORTH CENTRAL ZONE 4202 (U.S. SURVEY FEET) NORTHING (Y) 7,043,134.952 EASTING (X) 2,514,392.101		
GEOID MODEL: GEOID12B		NAVD-88 ELEVATION: 642.40 (U.S. SURVEY FEET)	

**NOTE:**

3-1/4 INCH ALUMINUM DISC SET ON THE WEST END OF A CURB INLET ON THE NORTH SIDE OF N. COLLINS BOULEVARD ±895 FEET WEST OF THE CENTERLINE OF ALAMO ROAD.

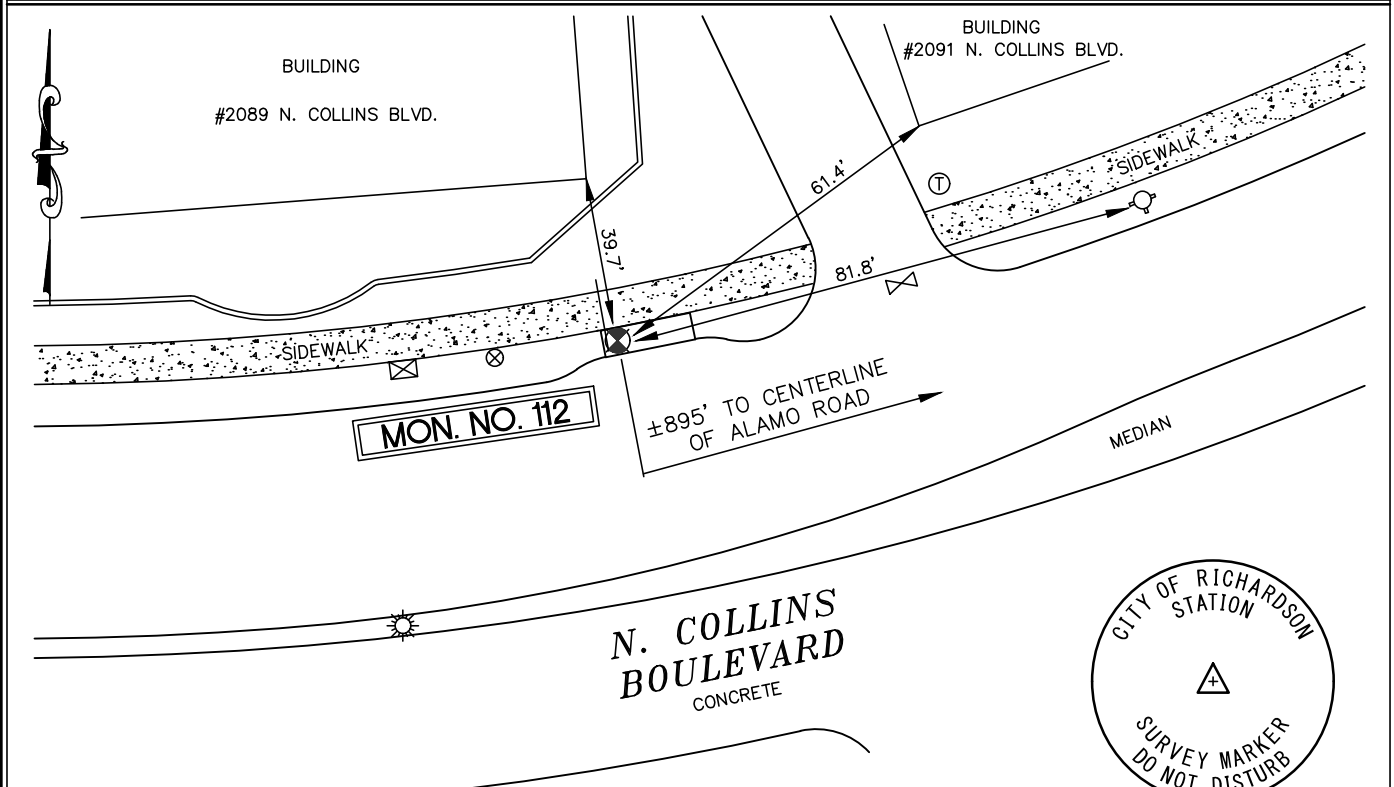

**N. COLLINS BOULEVARD**  
CONCRETE



**LEGEND**

- = MONUMENT
- = TELEPHONE RISER
- = FIRE HYDRANT
- = WATER VALVE
- = STREET LIGHT
- = WATER VAULT
- = WASTEWATER CLEAN OUT



(NOT TO SCALE)

# CITY OF RICHARDSON

## GPS CONTROL SHEET

Established By:



TBPELS FIRM NO. 10194115

MONUMENT NAME: MON. NO. 113	DATE ESTABLISHED: FEBRUARY 2020	COUNTY: DALLAS	STATE: TEXAS
GEODETIC POSITION LATITUDE N 32° 58' 44.48064" LONGITUDE W 96° 42' 00.02779"		GEOID03, NAD-83 (CORS 96) GRID DATA TEXAS STATE PLANE COORDINATES NORTH CENTRAL ZONE 4202 (METERS) NORTHING (Y) 2,146,967.911 EASTING (X) 768,225.332	
ELLIPSOID HEIGHT (METERS)	164.647	GEOID03, NAD-83 (CORS 96) GRID DATA TEXAS STATE PLANE COORDINATES NORTH CENTRAL ZONE 4202 (U.S. SURVEY FEET) NORTHING (Y) 7,043,843.888 EASTING (X) 2,520,419.277	
GEOID HEIGHT (METERS)	-26.042		
GEOID MODEL: GEOID12B		NAVD-88 ELEVATION: 625.62 (U.S. SURVEY FEET)	

**NOTE:**

3-1/4 INCH ALUMINUM DISC SET ON THE NORTH END OF A CURB INLET ON THE WEST SIDE OF N. PLANO ROAD ±1,477 FEET NORTH OF THE CENTERLINE OF E. CAMPBELL ROAD.

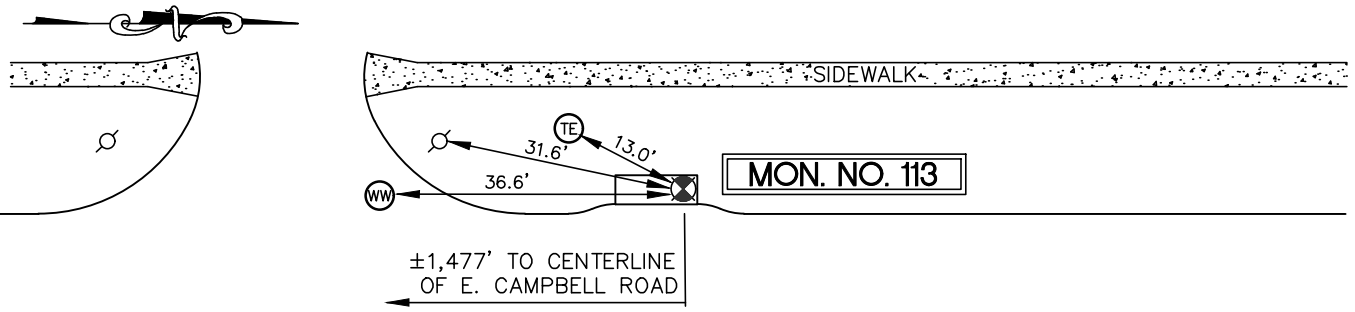

MEDIAN

*N. PLANO ROAD*

CONCRETE



**LEGEND**

- = MONUMENT
- = POWER POLE
- = WASTEWATER MANHOLE
- = TELEPHONE MANHOLE
- = WOODEN FENCE

(NOT TO SCALE)



# CITY OF RICHARDSON

## GPS CONTROL SHEET

Established By:



TBPELS FIRM NO. 10194115

<b>MONUMENT NAME:</b> MON. NO. 114	<b>DATE ESTABLISHED:</b> FEBRUARY 2020	<b>COUNTY:</b> DALLAS	<b>STATE:</b> TEXAS
<b>GEODETIC POSITION</b>  LATITUDE N 32° 58' 37.74954" LONGITUDE W 96° 41' 00.09035"		GEOID03, NAD-83 (CORS 96) GRID DATA TEXAS STATE PLANE COORDINATES NORTH CENTRAL ZONE 4202 (METERS) NORTHING (Y) 2,146,787.389 EASTING (X) 769,784.788	
ELLIPSOID HEIGHT (METERS)                      146.498  GEOID HEIGHT (METERS)                              -25.986	GEOID03, NAD-83 (CORS 96) GRID DATA TEXAS STATE PLANE COORDINATES NORTH CENTRAL ZONE 4202 (U.S. SURVEY FEET) NORTHING (Y) 7,043,251.625 EASTING (X) 2,525,535.592		
GEOID MODEL: GEOID12B		NAVD-88 ELEVATION: 565.89 (U.S. SURVEY FEET)	

**NOTE:**

3-1/4 INCH ALUMINUM DISC SET ON THE EAST END OF A CURB INLET ON THE NORTH SIDE OF CHESTNUT HILL LANE ±40 FEET WEST OF N. CLIFFE.

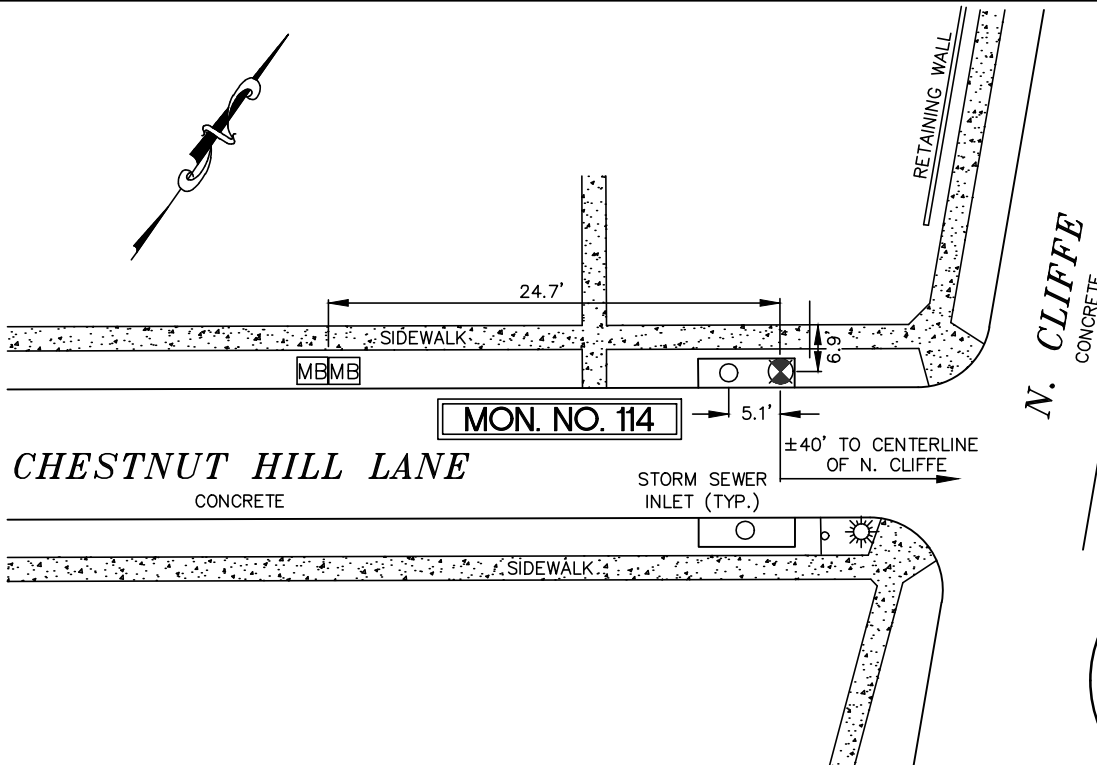

LEGEND	
⊕	= MONUMENT
⊖	= STREET SIGN
⊗	= WATER VALVE
☀	= STREET LIGHT



(NOT TO SCALE)

# CITY OF RICHARDSON

## GPS CONTROL SHEET

Established By:



TBPELS FIRM NO. 10194115

<b>MONUMENT NAME:</b> MON. NO. 115	<b>DATE ESTABLISHED:</b> FEBRUARY 2020	<b>COUNTY:</b> DALLAS	<b>STATE:</b> TEXAS
<b>GEODETTIC POSITION</b> LATITUDE N 32° 57' 37.76072" LONGITUDE W 96° 42' 00.55494"		GEOID03, NAD-83 (CORS 96) GRID DATA TEXAS STATE PLANE COORDINATES NORTH CENTRAL ZONE 4202 (METERS) NORTHING (Y) 2,144,912.821 EASTING (X) 768,246.857	
ELLIPSOID HEIGHT (METERS)                      161.646 GEOID HEIGHT (METERS)                            -26.052	GEOID03, NAD-83 (CORS 96) GRID DATA TEXAS STATE PLANE COORDINATES NORTH CENTRAL ZONE 4202 (U.S. SURVEY FEET) NORTHING (Y) 7,037,101.480 EASTING (X) 2,520,489.897		
<b>GEOID MODEL:</b> GEOID12B		<b>NAVD-88 ELEVATION:</b> 615.81 (U.S. SURVEY FEET)	

**NOTE:**

3-1/4 INCH ALUMINUM DISC SET IN THE SIDEWALK ON THE SOUTH SIDE OF ARAPAHO ROAD ±95 FEET WEST OF THE CENTERLINE OF N. PLANO ROAD.

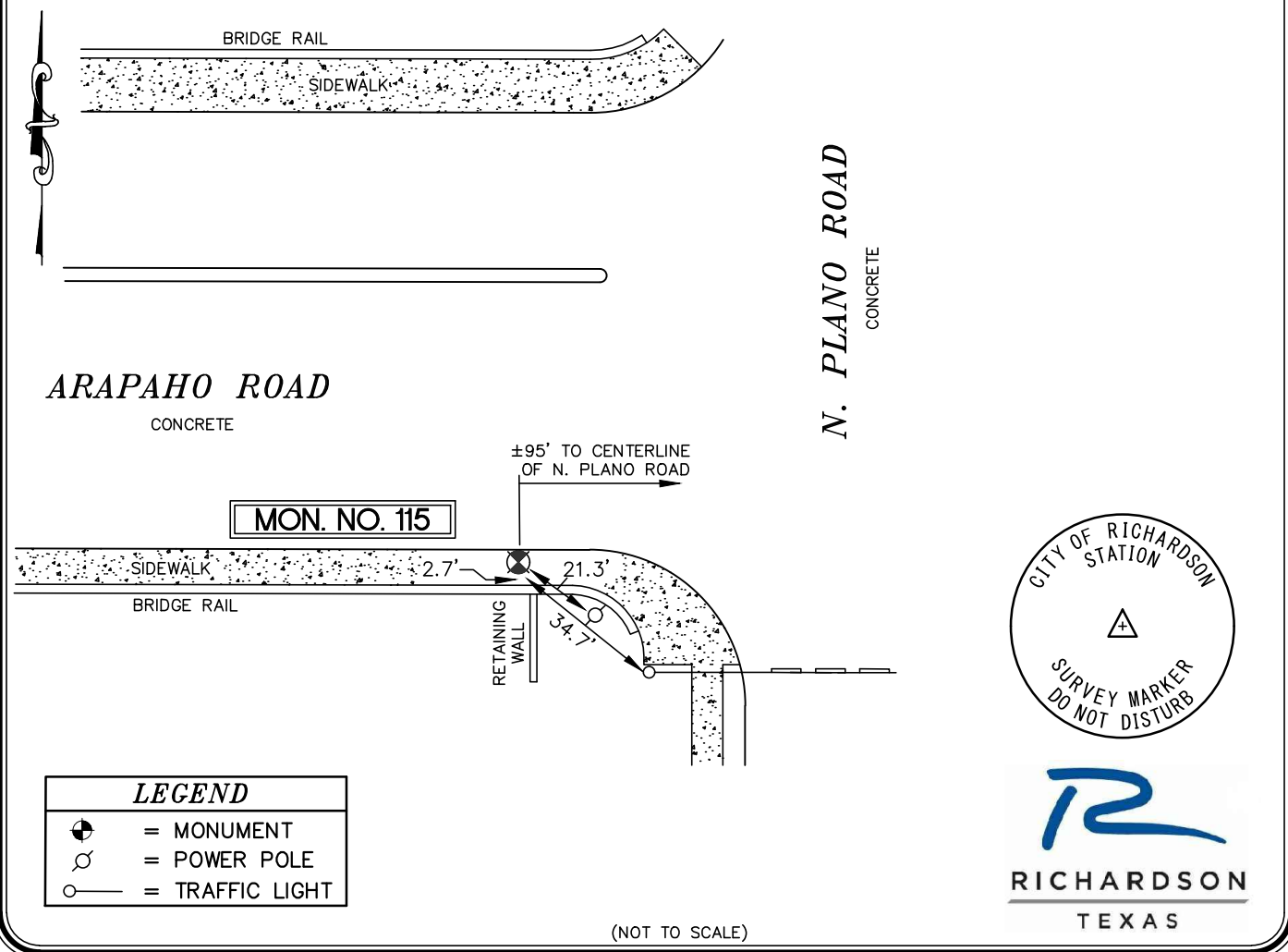

(NOT TO SCALE)

# CITY OF RICHARDSON

## GPS CONTROL SHEET

Established By:



TBPELS FIRM NO. 10194115

<b>MONUMENT NAME:</b> MON. NO. 116	<b>DATE ESTABLISHED:</b> FEBRUARY 2020	<b>COUNTY:</b> DALLAS	<b>STATE:</b> TEXAS
<b>GEODETIC POSITION</b>  LATITUDE N 32° 57' 43.82719" LONGITUDE W 96° 43' 25.10144"		GEOID03, NAD-83 (CORS 96) GRID DATA TEXAS STATE PLANE COORDINATES NORTH CENTRAL ZONE 4202 (METERS) NORTHING (Y) 2,145,062.291 EASTING (X) 766,048.553	
ELLIPSOID HEIGHT (METERS)                      179.279  GEOID HEIGHT (METERS)                              -26.135	GEOID03, NAD-83 (CORS 96) GRID DATA TEXAS STATE PLANE COORDINATES NORTH CENTRAL ZONE 4202 (U.S. SURVEY FEET) NORTHING (Y) 7,037,591.866 EASTING (X) 2,513,277.628		
GEOID MODEL: GEOID12B		NAVD-88 ELEVATION: 673.93 (U.S. SURVEY FEET)	

**NOTE:**

3-1/4 INCH BRASS DISC SET IN CONCRETE ±62.0 FEET SOUTHWEST OF THE CENTERLINE OF GREENVILLE AVENUE, ±578.0 FEET NORTHEAST OF THE CENTERLINE OF ARAPAHO ROAD.

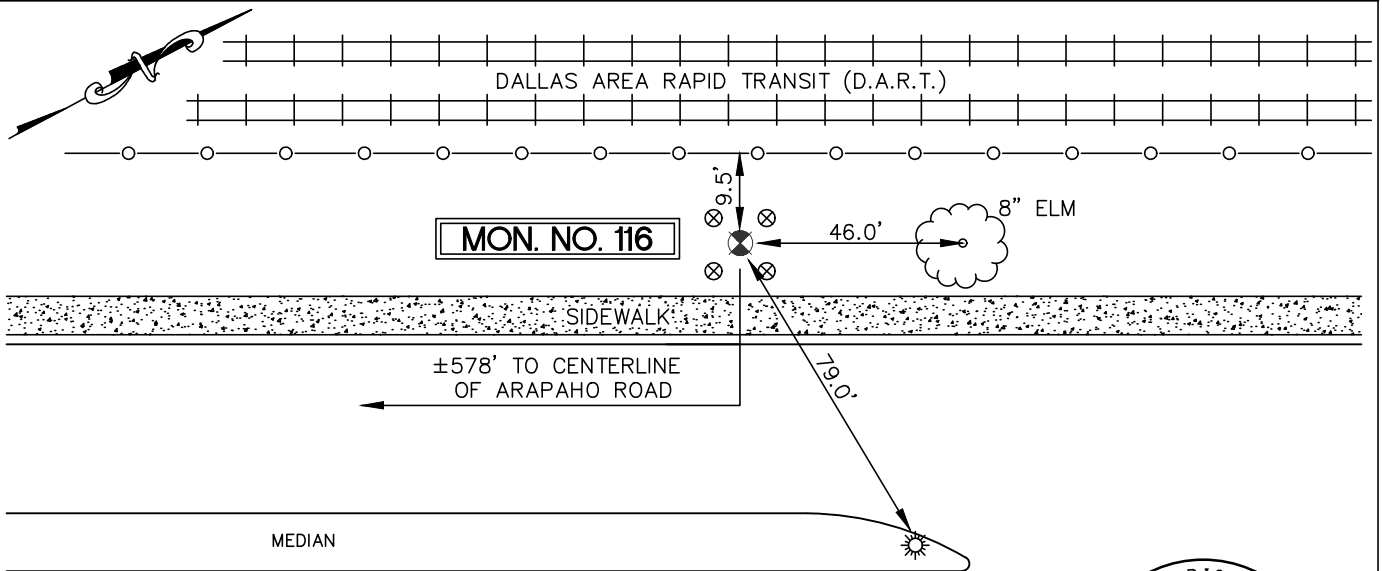

**GREENVILLE AVENUE**  
CONCRETE



<b>LEGEND</b>	
	= MONUMENT
	= LIGHT POLE
	= BOLLARD
	= RAILROAD TRACK
	= CHAINLINK FENCE
	= TREE

(NOT TO SCALE)

# CITY OF RICHARDSON

## GPS CONTROL SHEET

Established By:



TBPELS FIRM NO. 10194115

<b>MONUMENT NAME:</b> MON. NO. 117	<b>DATE ESTABLISHED:</b> FEBRUARY 2020	<b>COUNTY:</b> DALLAS	<b>STATE:</b> TEXAS
<b>GEODETIC POSITION</b> LATITUDE N 32° 57' 50.19671" LONGITUDE W 96° 45' 20.64989"		GEOID03, NAD-83 (CORS 96) GRID DATA TEXAS STATE PLANE COORDINATES NORTH CENTRAL ZONE 4202 (METERS) NORTHING (Y) 2,145,208.189 EASTING (X) 763,045.268	
ELLIPSOID HEIGHT (METERS)                      165.327 GEOID HEIGHT (METERS)                              -26.253	GEOID03, NAD-83 (CORS 96) GRID DATA TEXAS STATE PLANE COORDINATES NORTH CENTRAL ZONE 4202 (U.S. SURVEY FEET) NORTHING (Y) 7,038,070.533 EASTING (X) 2,503,424.350		
GEOID MODEL: GEOID12B		NAVD-88 ELEVATION: 628.54 (U.S. SURVEY FEET)	

**NOTE:**

3-1/4 INCH ALUMINUM DISC SET ON THE SOUTH END OF A CURB INLET AT THE NORTHEAST INTERSECTION OF N. WATERVIEW DRIVE AND WARFIELD WAY.

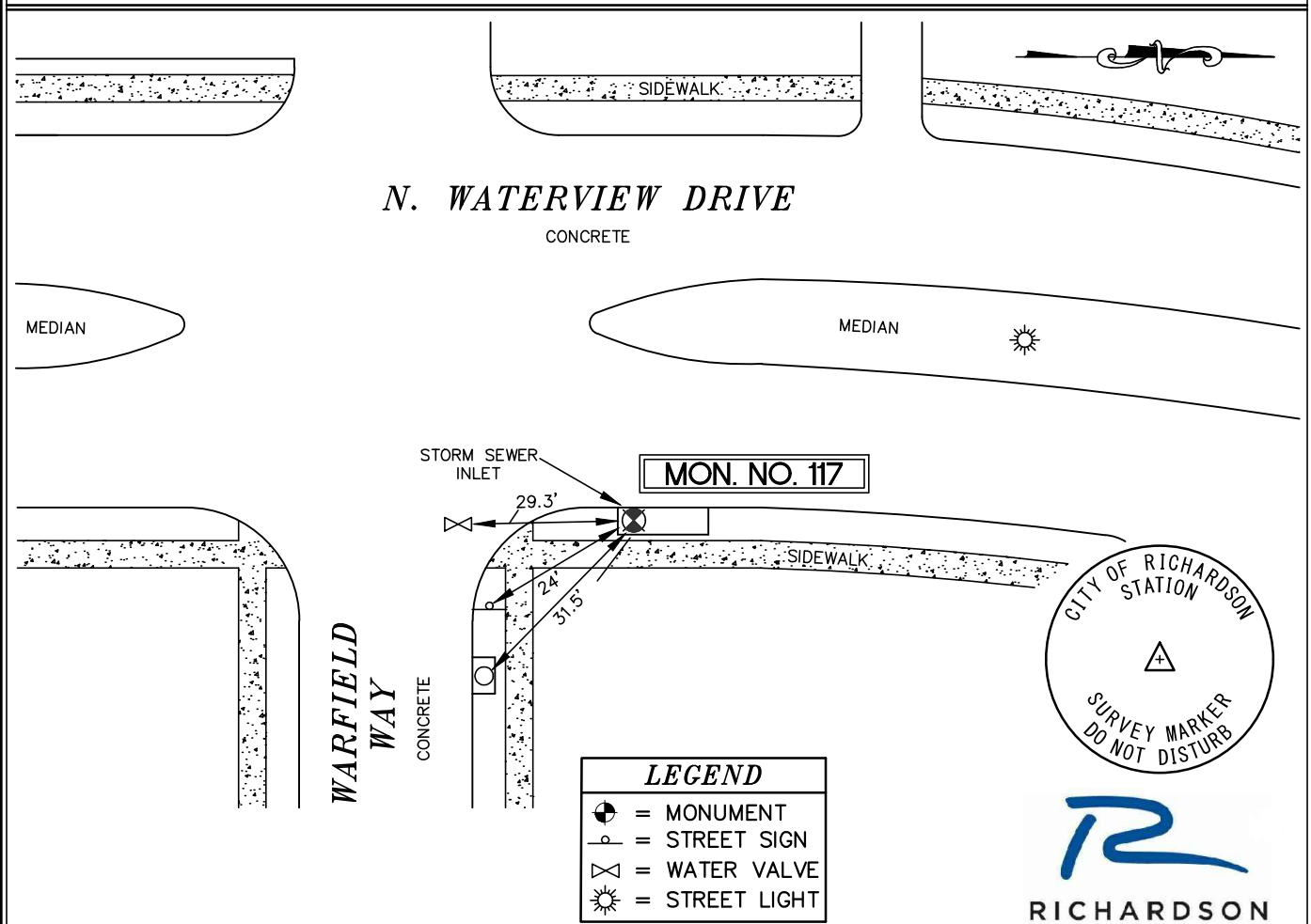

(NOT TO SCALE)



# CITY OF RICHARDSON

## GPS CONTROL SHEET

Established By:



TBPELS FIRM NO. 10194115

<b>MONUMENT NAME:</b> MON. NO. 118	<b>DATE ESTABLISHED:</b> FEBRUARY 2020	<b>COUNTY:</b> DALLAS	<b>STATE:</b> TEXAS
<b>GEODETTIC POSITION</b> LATITUDE N 32° 56' 48.75727" LONGITUDE W 96° 45' 53.10889"		GEOID03, NAD-83 (CORS 96) GRID DATA TEXAS STATE PLANE COORDINATES NORTH CENTRAL ZONE 4202 (METERS) NORTHING (Y) 2,143,301.989 EASTING (X) 762,233.795	
ELLIPSOID HEIGHT (METERS)                      157.295 GEOID HEIGHT (METERS)                              -26.299	GEOID03, NAD-83 (CORS 96) GRID DATA TEXAS STATE PLANE COORDINATES NORTH CENTRAL ZONE 4202 (U.S. SURVEY FEET) NORTHING (Y) 7,031,816.609 EASTING (X) 2,500,762.042		
GEOID MODEL: GEOID12B		NAVD-88 ELEVATION: 602.34 (U.S. SURVEY FEET)	

**NOTE:**

3-1/4 INCH ALUMINUM DISC SET ON THE EAST END OF A CURB INLET ON THE NORTH SIDE OF DUMONT DRIVE ±1,324 FEET EAST OF THE CENTERLINE OF S. COIT ROAD, ON THE EAST SIDE OF A CREEK AT THE SOUTH END OF COTTONWOOD PARK

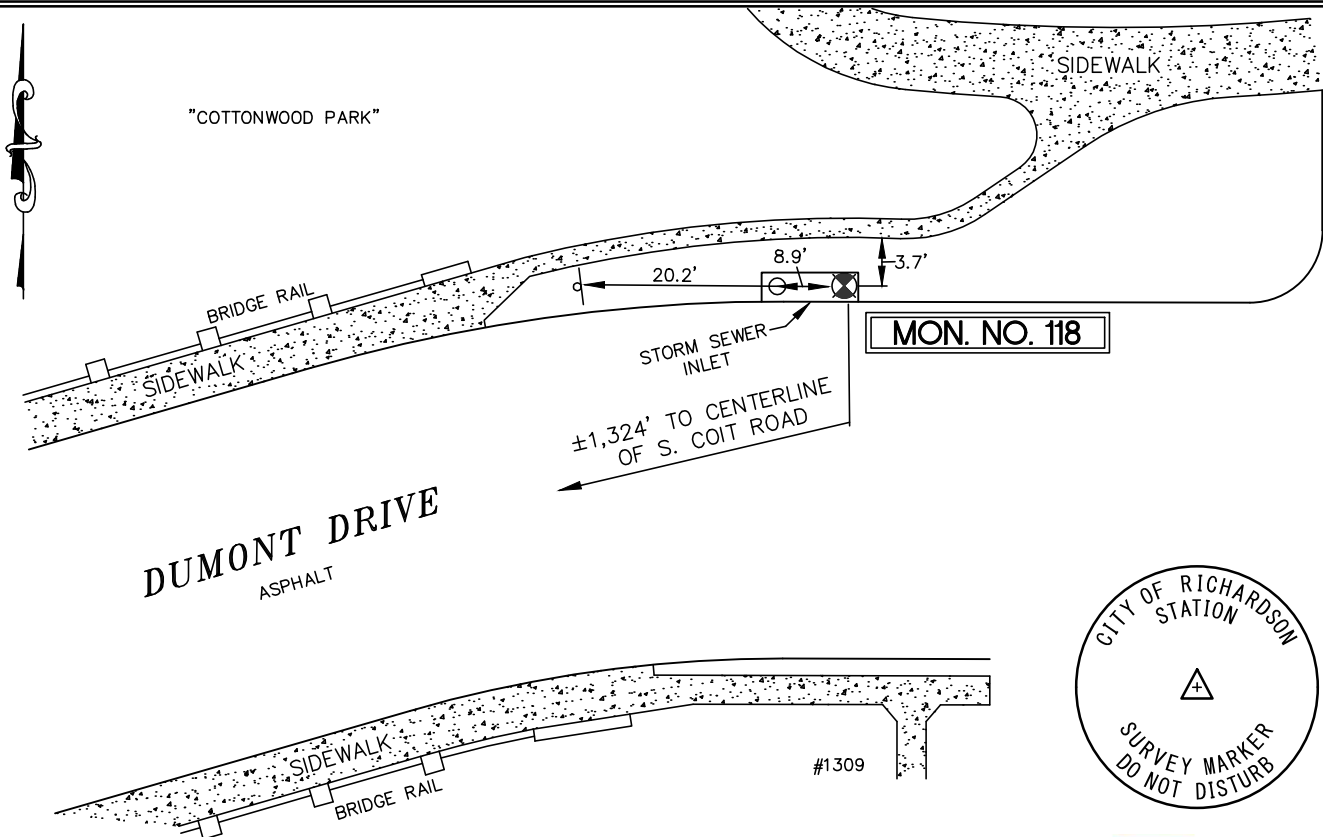

**MON. NO. 118**



<b>LEGEND</b>	
	= MONUMENT
	= STREET SIGN



(NOT TO SCALE)

# CITY OF RICHARDSON

## GPS CONTROL SHEET

Established By:



TBPELS FIRM NO. 10194115

<b>MONUMENT NAME:</b> MON. NO. 119	<b>DATE ESTABLISHED:</b> FEBRUARY 2020	<b>COUNTY:</b> DALLAS	<b>STATE:</b> TEXAS
<b>GEODETTIC POSITION</b> LATITUDE N 32° 57' 03.88692" LONGITUDE W 96° 44' 47.98558"		GEOID03, NAD-83 (CORS 96) GRID DATA TEXAS STATE PLANE COORDINATES NORTH CENTRAL ZONE 4202 (METERS) NORTHING (Y) 2,143,796.039 EASTING (X) 763,917.134	
ELLIPSOID HEIGHT (METERS)                      160.366 GEOID HEIGHT (METERS)                              -26.228	GEOID03, NAD-83 (CORS 96) GRID DATA TEXAS STATE PLANE COORDINATES NORTH CENTRAL ZONE 4202 (U.S. SURVEY FEET) NORTHING (Y) 7,033,437.505 EASTING (X) 2,506,284.797		
GEOID MODEL: GEOID12B		NAVD-88 ELEVATION: 612.18 (U.S. SURVEY FEET)	

**NOTE:**

3-1/4 INCH ALUMINUM DISC SET ON THE BACK CORNER OF A CURB INLET ON THE NORTH SIDE OF W. BELTLINE ROAD ±816 FEET WEST OF THE CENTERLINE OF N. FLOYD ROAD.

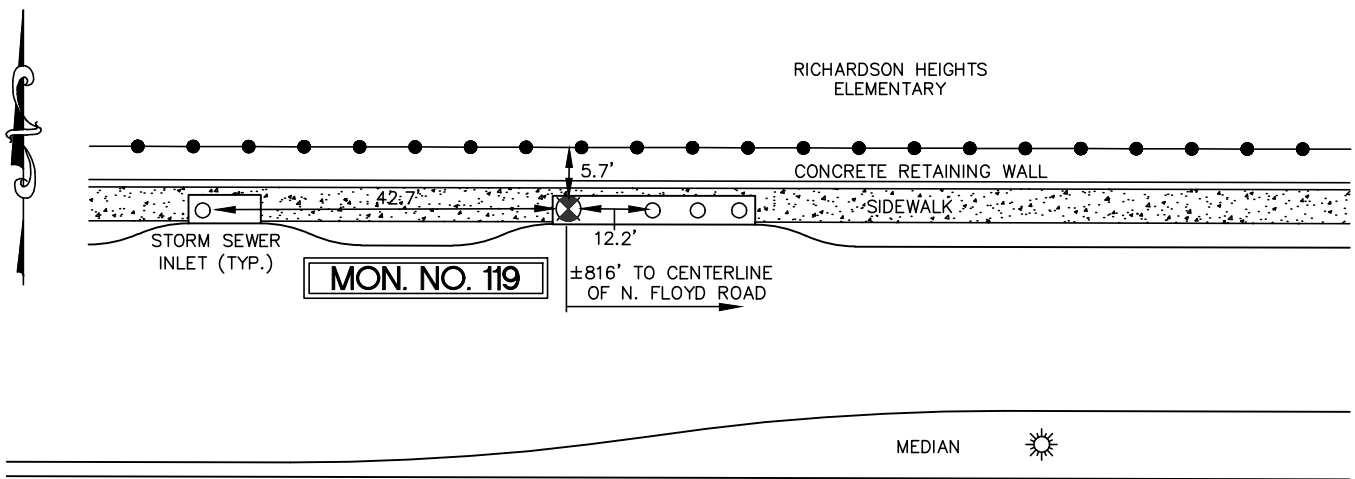

### W. BELTLINE ROAD

CONCRETE

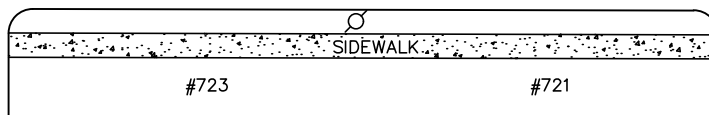
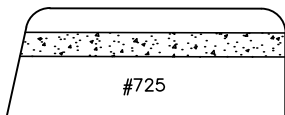

**LEGEND**

- = MONUMENT
- = POWER POLE
- = TRAFFIC LIGHT
- = STREET LIGHT
- = WOODEN FENCE



(NOT TO SCALE)



# CITY OF RICHARDSON

## GPS CONTROL SHEET

Established By:



TBPELS FIRM NO. 10194115

MONUMENT NAME: MON. NO. 120	DATE ESTABLISHED: FEBRUARY 2020	COUNTY: DALLAS	STATE: TEXAS
GEODETTIC POSITION LATITUDE N 32° 56' 42.86821" LONGITUDE W 96° 43' 32.61997"		GEOID03, NAD-83 (CORS 96) GRID DATA TEXAS STATE PLANE COORDINATES NORTH CENTRAL ZONE 4202 (METERS) NORTHING (Y) 2,143,181.560 EASTING (X) 765,885.065	
ELLIPSOID HEIGHT (METERS)	167.188	GEOID03, NAD-83 (CORS 96) GRID DATA TEXAS STATE PLANE COORDINATES NORTH CENTRAL ZONE 4202 (U.S. SURVEY FEET) NORTHING (Y) 7,031,421.502 EASTING (X) 2,512,741.251	
GEOID HEIGHT (METERS)	-26.162		
GEOID MODEL: GEOID12B		NAVD-88 ELEVATION: 634.35 (U.S. SURVEY FEET)	

**NOTE:**

3-1/4 INCH ALUMINUM DISC SET ON THE BACK CORNER OF A CURB INLET ON THE SOUTH SIDE OF FRANCES WAY ±45 FEET EAST OF THE CENTERLINE OF BETTY DRIVE.

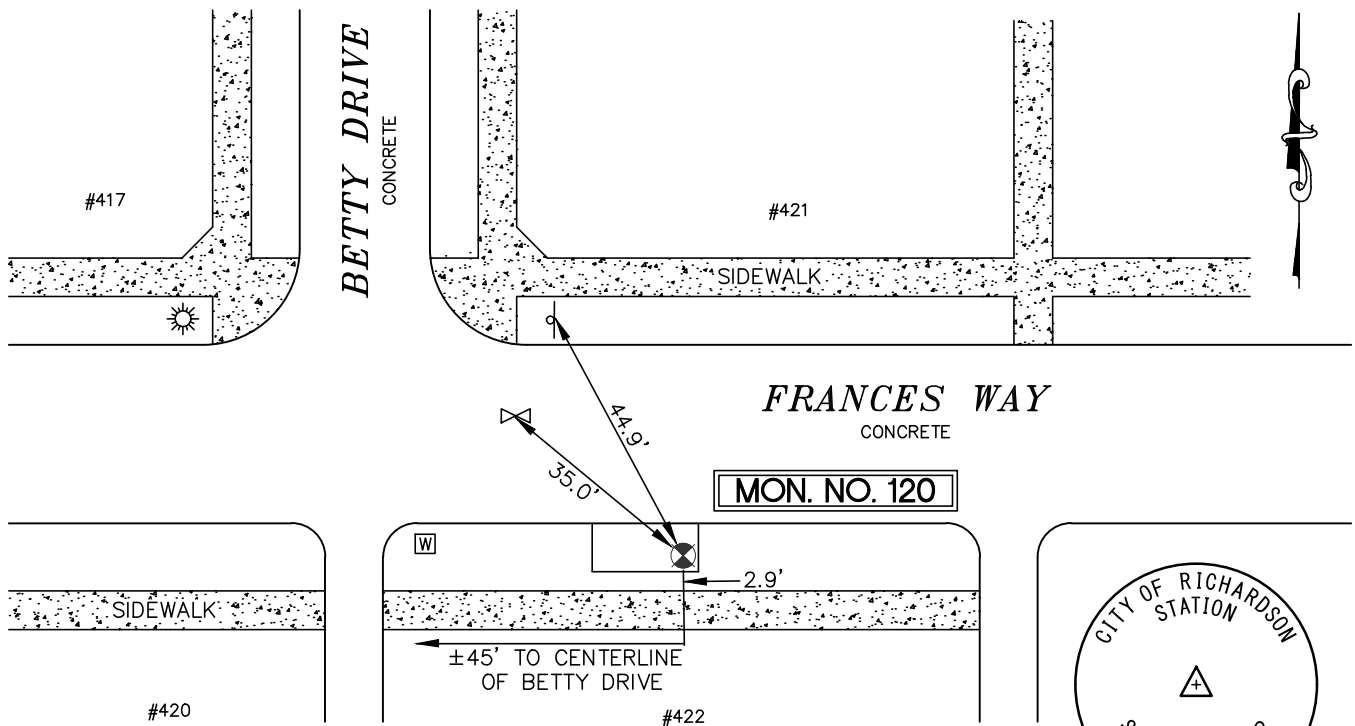

<i>LEGEND</i>	
⊙	= MONUMENT
	= STREET SIGN
☀	= STREET LIGHT
W	= WATER METER
X	= WATER VALVE



(NOT TO SCALE)

# CITY OF RICHARDSON

## GPS CONTROL SHEET

Established By:



TBPELS FIRM NO. 10194115

<b>MONUMENT NAME:</b> MON. NO. 121	<b>DATE ESTABLISHED:</b> FEBRUARY 2020	<b>COUNTY:</b> DALLAS	<b>STATE:</b> TEXAS
<b>GEODETTIC POSITION</b> LATITUDE N 32° 56' 42.90907" LONGITUDE W 96° 42' 00.58759"		GEOID03, NAD-83 (CORS 96) GRID DATA TEXAS STATE PLANE COORDINATES NORTH CENTRAL ZONE 4202 (METERS) NORTHING (Y) 2,143,223.476 EASTING (X) 768,274.954	
ELLIPSOID HEIGHT (METERS)                      164.847  GEOID HEIGHT (METERS)                              -26.060	GEOID03, NAD-83 (CORS 96) GRID DATA TEXAS STATE PLANE COORDINATES NORTH CENTRAL ZONE 4202 (U.S. SURVEY FEET) NORTHING (Y) 7,031,559.021 EASTING (X) 2,520,582.078		
GEOID MODEL: GEOID12B		NAVD-88 ELEVATION: 626.33 (U.S. SURVEY FEET)	

**NOTE:**

3-1/4 INCH ALUMINUM DISC SET ON THE BACK CORNER OF A CURB INLET ON THE SOUTH SIDE OF E. BELTLINE ROAD ±98 FEET WEST OF THE CENTERLINE OF S. PLANO ROAD.

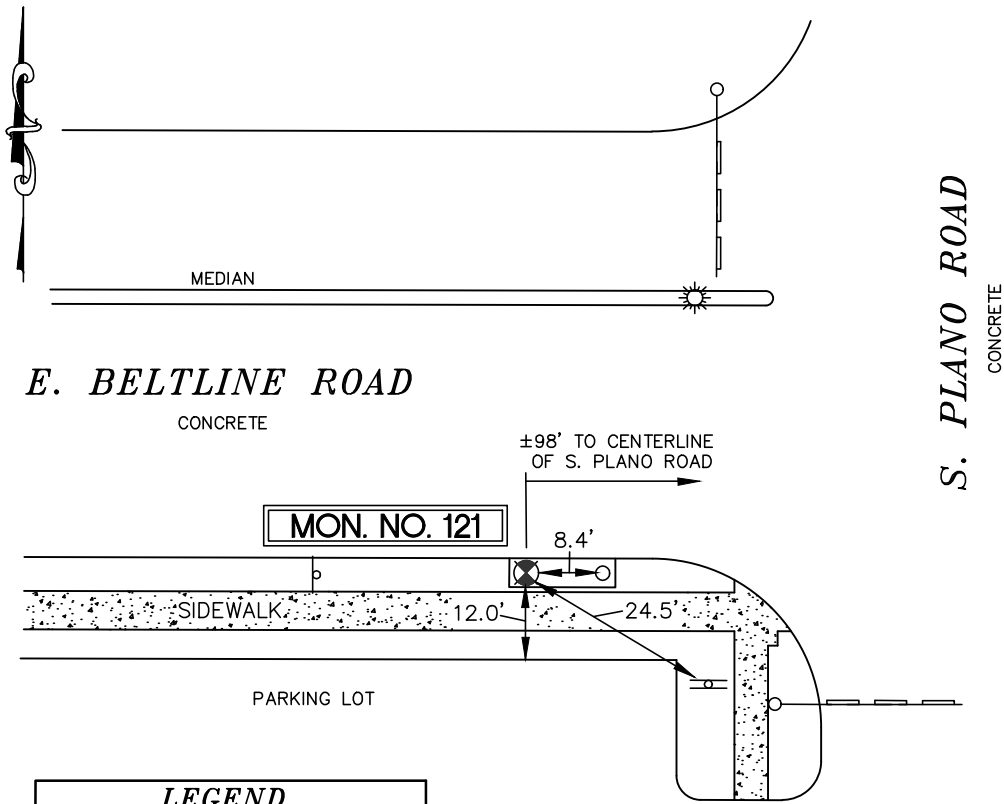

<b>LEGEND</b>	
	= MONUMENT
	= STREET LIGHT
	= STREET SIGN
	= DOUBLE SIDED SIGN
	= TRAFFIC LIGHT



(NOT TO SCALE)

# CITY OF RICHARDSON

## GPS CONTROL SHEET

Established By:



TBPELS FIRM NO. 10194115

<b>MONUMENT NAME:</b> MON. NO. 122	<b>DATE ESTABLISHED:</b> FEBRUARY 2020	<b>COUNTY:</b> DALLAS	<b>STATE:</b> TEXAS
<b>GEODETTIC POSITION</b> LATITUDE N 32° 56' 49.06230" LONGITUDE W 96° 40' 57.99612"		GEOID03, NAD-83 (CORS 96) GRID DATA TEXAS STATE PLANE COORDINATES NORTH CENTRAL ZONE 4202 (METERS) NORTHING (Y) 2,143,440.968 EASTING (X) 769,897.061	
ELLIPSOID HEIGHT (METERS)                      156.995 GEOID HEIGHT (METERS)                              -25.997	GEOID03, NAD-83 (CORS 96) GRID DATA TEXAS STATE PLANE COORDINATES NORTH CENTRAL ZONE 4202 (U.S. SURVEY FEET) NORTHING (Y) 7,032,272.576 EASTING (X) 2,525,903.941		
GEOID MODEL: GEOID12B		NAVD-88 ELEVATION: 600.37 (U.S. SURVEY FEET)	

**NOTE:**

3-1/4 INCH ALUMINUM DISC SET IN THE CENTER OF THE MEDIAN OF N. JUPITER ROAD AT THE ENTRANCE TO CALI SAIGON MALL ±620 FEET WEST OF THE CENTERLINE OF E. BELTLINE ROAD.

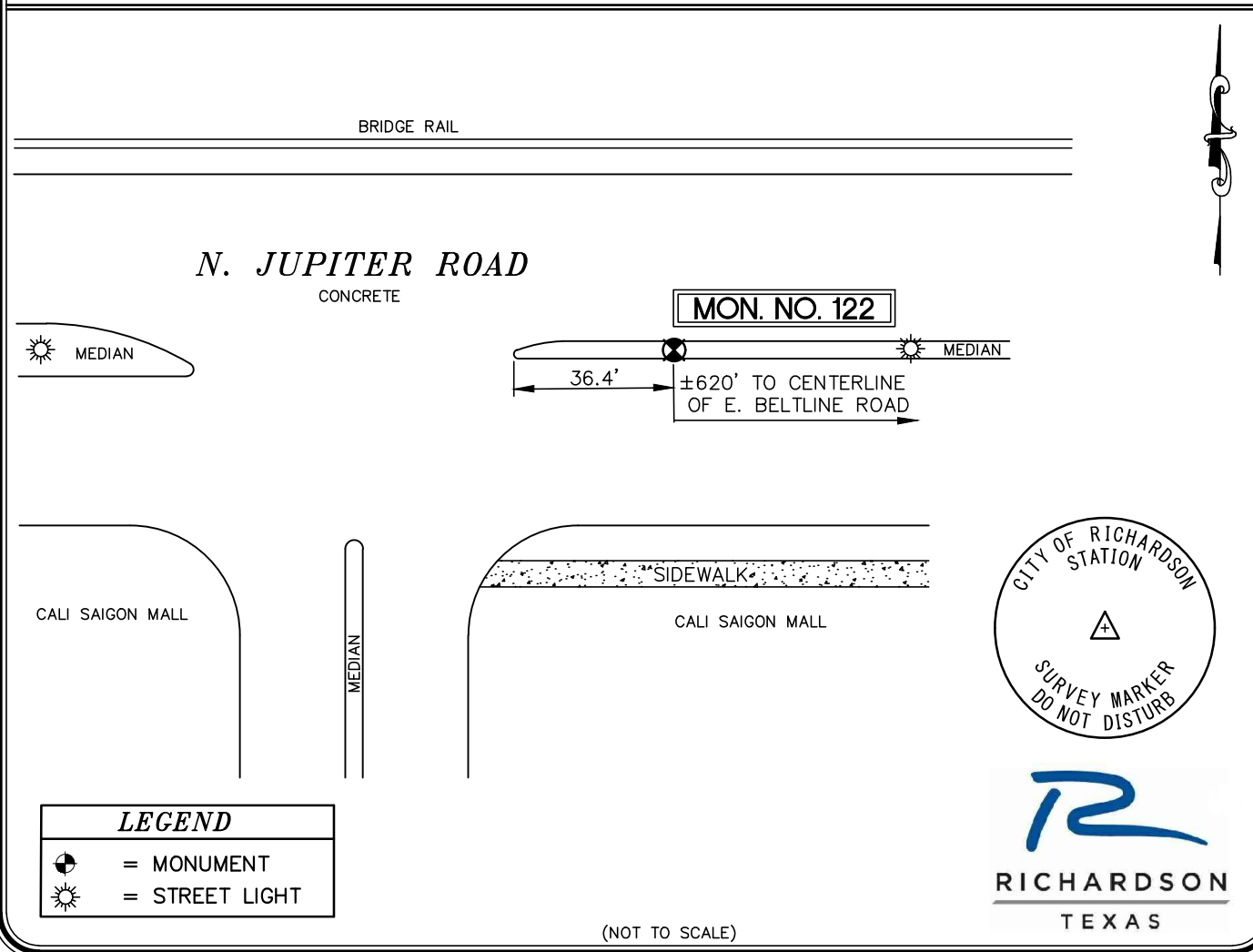

(NOT TO SCALE)

# CITY OF RICHARDSON

## GPS CONTROL SHEET

Established By:



TBPELS FIRM NO. 10194115

<b>MONUMENT NAME:</b> MON. NO. 123	<b>DATE ESTABLISHED:</b> FEBRUARY 2020	<b>COUNTY:</b> DALLAS	<b>STATE:</b> TEXAS
<b>GEODETTIC POSITION</b>  LATITUDE N 32° 55' 52.71517" LONGITUDE W 96° 41' 02.41843"		GEOID03, NAD-83 (CORS 96) GRID DATA TEXAS STATE PLANE COORDINATES NORTH CENTRAL ZONE 4202 (METERS) NORTHING (Y) 2,141,703.602 EASTING (X) 769,812.224	
ELLIPSOID HEIGHT (METERS) 160.335  GEOID HEIGHT (METERS) -26.011		GEOID03, NAD-83 (CORS 96) GRID DATA TEXAS STATE PLANE COORDINATES NORTH CENTRAL ZONE 4202 (U.S. SURVEY FEET) NORTHING (Y) 7,026,572.568 EASTING (X) 2,525,625.605	
GEOID MODEL: GEOID12B		NAVD-88 ELEVATION: 611.37 (U.S. SURVEY FEET)	

**NOTE:**

3-1/4 INCH ALUMINUM DISC SET ON THE BACK CORNER OF A CURB INLET ON THE NORTH SIDE OF W. BUCKINGHAM ROAD ±328 FEET WEST OF THE CENTERLINE OF N. JUPITER ROAD.

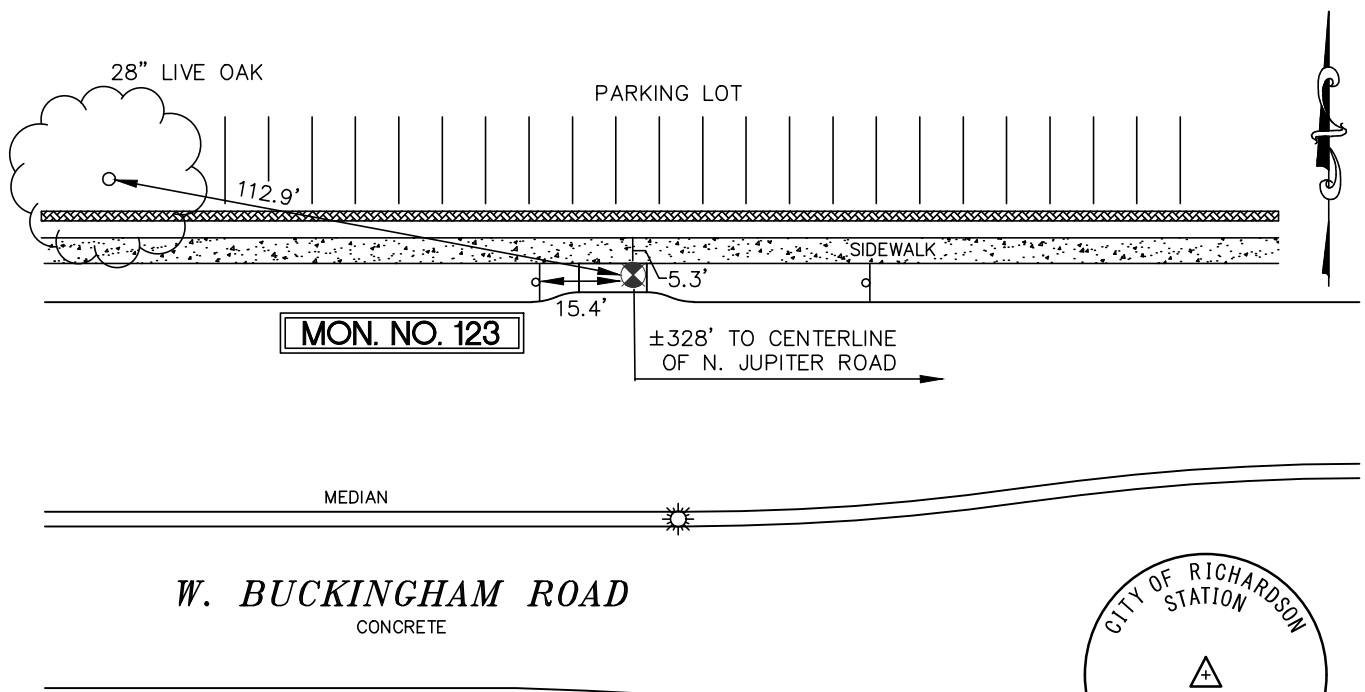

**W. BUCKINGHAM ROAD**  
 CONCRETE



<b>LEGEND</b>	
	= MONUMENT
	= STREET SIGN
	= STREET LIGHT
	= TREE



(NOT TO SCALE)

# CITY OF RICHARDSON

## GPS CONTROL SHEET

Established By:



TBPELS FIRM NO. 10194115

<b>MONUMENT NAME:</b> MON. NO. 124	<b>DATE ESTABLISHED:</b> FEBRUARY 2020	<b>COUNTY:</b> DALLAS	<b>STATE:</b> TEXAS
<b>GEODETTIC POSITION</b>  LATITUDE N 32° 56' 08.39238" LONGITUDE W 96° 42' 50.05134"		GEOID03, NAD-83 (CORS 96) GRID DATA TEXAS STATE PLANE COORDINATES NORTH CENTRAL ZONE 4202 (METERS) NORTHING (Y) 2,142,138.500 EASTING (X) 767,008.545	
ELLIPSOID HEIGHT (METERS)	170.096	GEOID03, NAD-83 (CORS 96) GRID DATA TEXAS STATE PLANE COORDINATES NORTH CENTRAL ZONE 4202 (U.S. SURVEY FEET) NORTHING (Y) 7,027,999.395 EASTING (X) 2,516,427.201	
GEOID HEIGHT (METERS)	-26.115	NAVD-88 ELEVATION: 643.74 (U.S. SURVEY FEET)	
GEOID MODEL: GEOID12B		NAVD-88 ELEVATION: 643.74 (U.S. SURVEY FEET)	

**NOTE:**

3-1/4 INCH ALUMINUM DISC SET ON THE EAST END OF A CURB INLET ON THE NORTH SIDE OF CENTENNIAL BOULEVARD ±1,590 FEET EAST OF THE CENTERLINE OF S. GROVE ROAD AND ±142 FEET WEST OF THE RAILROAD TRACK.

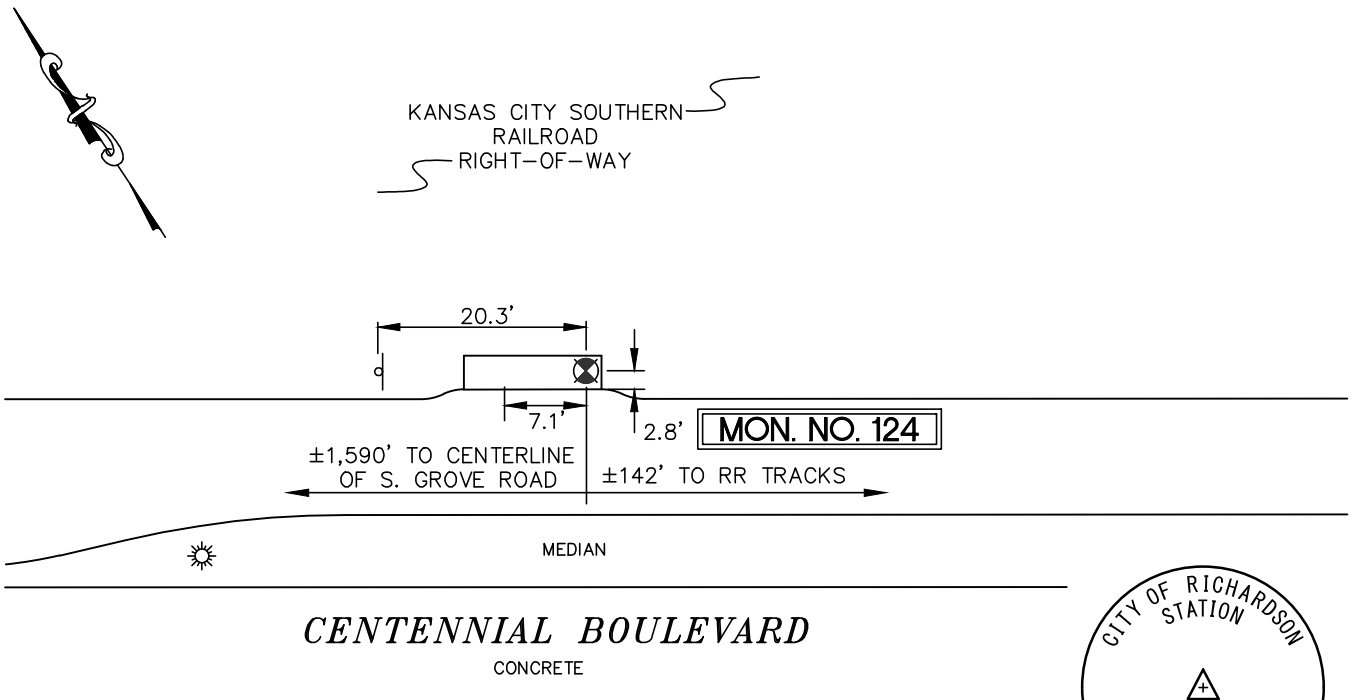

<b>LEGEND</b>	
	= MONUMENT
	= LIGHT POLE
	= STREET SIGN

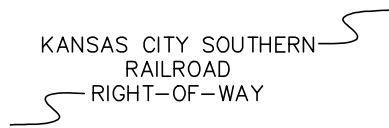

(NOT TO SCALE)

# CITY OF RICHARDSON

## GPS CONTROL SHEET

Established By:



TBPELS FIRM NO. 10194115

<b>MONUMENT NAME:</b> MON. NO. 125	<b>DATE ESTABLISHED:</b> FEBRUARY 2020	<b>COUNTY:</b> DALLAS	<b>STATE:</b> TEXAS
<b>GEODETTIC POSITION</b> LATITUDE N 32° 55' 24.36146" LONGITUDE W 96° 44' 24.02207"		GEOID03, NAD-83 (CORS 96) GRID DATA TEXAS STATE PLANE COORDINATES NORTH CENTRAL ZONE 4202 (METERS) NORTHING (Y) 2,140,741.231 EASTING (X) 764,590.743	
ELLIPSOID HEIGHT (METERS)                      153.205 GEOID HEIGHT (METERS)                              -26.221	GEOID03, NAD-83 (CORS 96) GRID DATA TEXAS STATE PLANE COORDINATES NORTH CENTRAL ZONE 4202 (U.S. SURVEY FEET) NORTHING (Y) 7,023,415.189 EASTING (X) 2,508,494.796		
GEOID MODEL: GEOID12B		NAVD-88 ELEVATION: 588.67 (U.S. SURVEY FEET)	

**NOTE:**

3-1/4 INCH ALUMINUM DISC SET IN THE BACK CENTER OF A CURB INLET AT THE INTERSECTION OF THE SOUTHEAST SIDE OF GREENVILLE AVENUE WITH THE NORTH SIDE OF WALNUT STREET ±112 FEET NORTHEAST OF THE CENTERLINE OF WALNUT STREET.

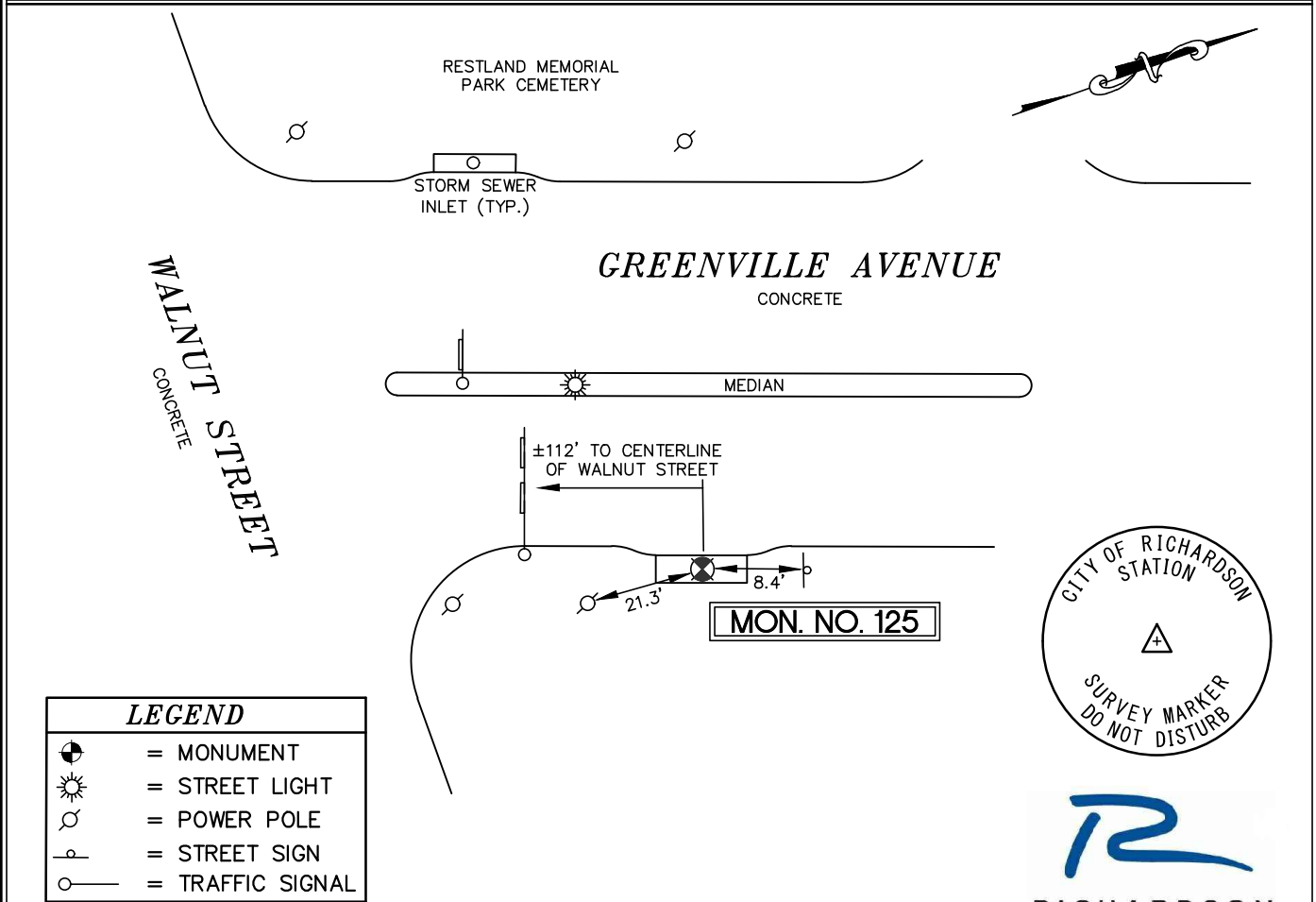

<b>LEGEND</b>	
	= MONUMENT
	= STREET LIGHT
	= POWER POLE
	= STREET SIGN
	= TRAFFIC SIGNAL

(NOT TO SCALE)



## **CITY OF RICHARDSON GPS CONTROL NETWORK**

### **BASIS FOR CONTROL**

The values for the City of Richardson GPS Control Network were established using Static data collection procedures during the month of February 2020. CP&Y, Inc., in conjunction with the City of Richardson set all 3-1/4 inch domed aluminum monuments throughout the City at designated key areas. All fieldwork and post processing were performed by CP&Y, Inc. Final data sheets were published after consultation with the City of Richardson.

Horizontal State Plane Coordinates (SPC) are on the Lambert Projection System — NAD83 (CORS96) — Texas Coordinate System (Texas North Central Zone 4202). A position was derived using the National Geodetic Service (NGS) Online Positioning User Service (OPUS) position for Monument No. 116 (previously City of Richardson Monument H7) near the center of Richardson, as a base point. All other monuments within the City of Richardson were tied to a constellation of multiple observations (baselines) using 3 GPS receivers from this base point location. The vectors were assembled into a three-dimensional network least squares model using the Trimble Business Center® software. A minimally constrained adjustment proved the integrity of the vector data. The positions of four Continuously Operating Reference Stations (CORS) in the NGS network were included in the project as control and the vectors from each of these stations were used to develop coordinates for Monument No. 116. The resulting coordinate values for all stations matched the OPUS solution and separate vector data corrected from the Trimble RTKNet. The dual-frequency vectors were added to the project to obtain coordinates for all stations for publication.

Vertical values are NAVD88 elevations and validated by the City of Richardson Control Network generated in 1990, OPUS, and Trimble RTKNet datums. The 1990 City of Richardson Control Network was previously adjusted to the Federal Emergency Management Agency (FEMA) with GPS Static observations on U.S. Coast & Geodetic Survey Monuments M923 and S923. All GPS derived elevations were computed using a Geoid Model (GEOID12B).

In summary, CP&Y, Inc. provided the City of Richardson with a GPS Control Network based on the position of Monument No. 116 and its elevation verified from the City of Richardson 1990 Control Network. All data sheets will show State Plane Coordinates in both Geodetic and Grid formats. The horizontal data is referenced to NAD83 Texas North Central Zone- 4202, in both U.S. Survey feet and meters. Vertical data is referenced to NAVD88 elevations.

# GPS CONTROL NETWORK

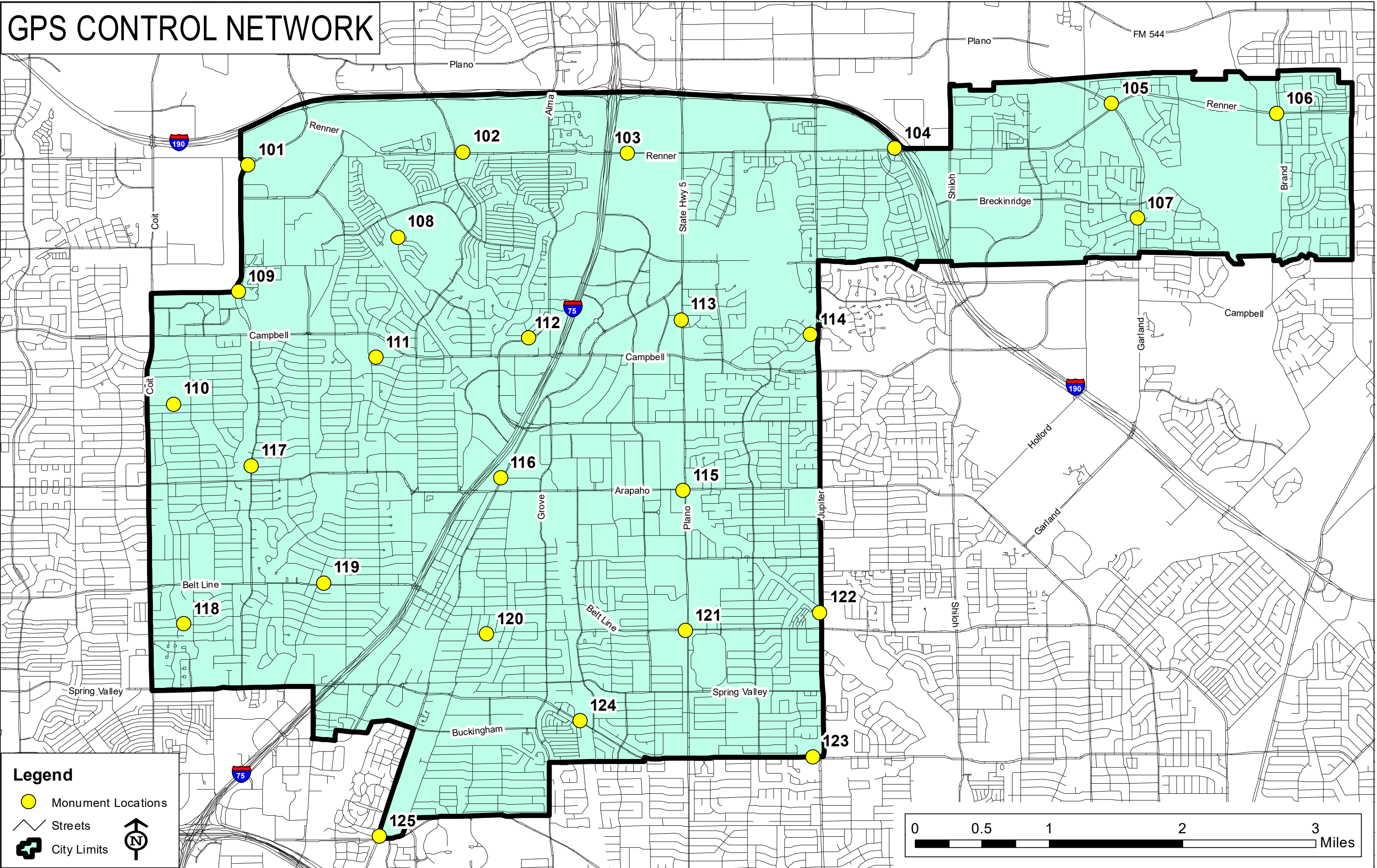

**Legend**

- Monument Locations
- Streets
- ⊕ City Limits





City of Richardson  
Engineering Department  
411 West Arapaho Road, Suite 204  
Richardson, TX 75080  
972.744.4280

Prepared by:



Partners for a Better Quality of Life  
[www.cpyi.com](http://www.cpyi.com)